

POWERED BY  
**DUALSKY**



Xmotor  
**GA SERIES**



Xmotor  
**EA SERIES**



**PHO**  
BRUSHLESS SYSTEMS **V2**

Xmotor  
**ECO SERIES**



Vol.20

**双天无刷电机  
& 驱动[无人机]**

Brushless Motor Lineup For Drones

上海双天模型有限公司  
Shanghai Dualsky Models Co.,Ltd.

## Xmotor GA Series

GA800 MKII	<u>1</u>	30E to 40E F3A, 3D airplanes, FAI F2B
GA1500R MKII	<u>2</u>	70E to 90E, 3D airplanes
GA2000R MKII	<u>3</u>	110E to 120E, 3D airplanes
GA3500R	<u>4</u>	35cc, 3D airplanes
GA4000	<u>5</u>	35 - 40cc, 3D airplanes, UAV
GA6000	<u>6</u>	55 - 60cc, 3D airplanes, UAV
GA8000	<u>7</u>	80 - 120cc, 3D and scale warbird airplanes, UAV

## Xmotor EA Series

2834EA	<u>8</u>	15E, 480class
2838EA	<u>9</u>	15E Plus, 550 class
3542EA	<u>10</u>	25E, Up to .25 2st
3548EA	<u>11</u>	32E, .25-.32 2-stroke
4255EA	<u>12</u>	55E,.35-.55 2-stroke. Up to .60 4st
5050EA	<u>13</u>	70E,.50-.60 2-stroke. Up to .82 4st, UAV
5060EA	<u>14</u>	90E, .75-.90 2-stroke Up to .110 4st, UAV
6352EA	<u>15-16</u>	125E, .95-.120 2-stroke. Up to .140 4st
6360EA	<u>17</u>	170E, .140-.170 2-stroke. Up to .200 4st

## Xmotor ECO Series

2303ECO	<u>18</u>	3520ECO	<u>28</u>
2304ECO	<u>19</u>	4120ECO	<u>29</u>
2306ECO	<u>20</u>	4130ECO	<u>30</u>
2308ECO	<u>21</u>	5322ECO	<u>31</u>
2312ECO	<u>22</u>	5330ECO	<u>32</u>
2316ECO	<u>23</u>		
2808ECO	<u>24</u>		
2814ECO	<u>25</u>		
2820ECO	<u>26</u>		
2826ECO	<u>27</u>		



# 功率密度 Power Density



Xmotor ECO Series



Xmotor EA Series



Xmotor GA Series

**高效率**  
**High Efficient**

Xmotor ECO Series

**高性能**  
**High Performance**

Xmotor EA Series

**极致动力**  
**Extreme Power**

Xmotor GA Series



5330ECO

5322ECO

4130ECO



4120ECO

3520ECO

2826ECO

2820ECO



2814ECO

2316ECO

2312ECO

2306ECO



2304ECO

2303ECO



6360EA

6352EA

5060EA



5050EA

4255EA

3548EA

3542EA

2838EA



2834EA

9000w

GA8000

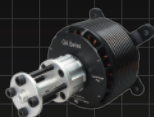

6000W

GA6000

4000W

GA4000

3800W

3500W

GA3500R



2500w

2000w

GA2000R MKII



1500w

GA1500R MKII

1240w

1000w

960w

800w

GA800 MKII



660w

540w

480w

400w

300w

260w

200w

120w

80w



双天动力系列天梯图

Dualsky power series ladder diagram

## Dimension 尺寸图

(Unit : mm)

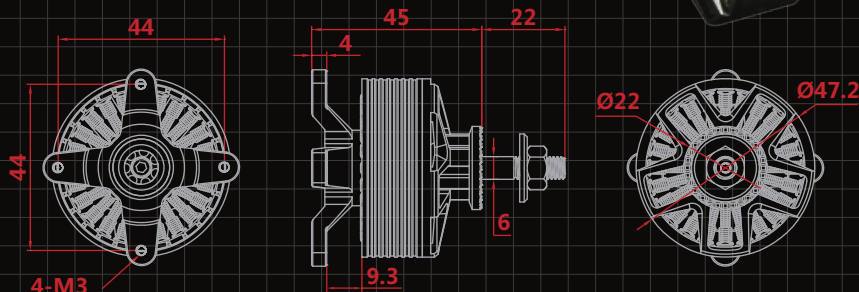

## Specification 规格

GA RACING SERIES	GA800.15 MKII	GA800.19 MKII	GA800.23 MKII
SKU (商品编码)	52253	52254	52255
KV (KV值)	810	640	530
Weight(g) (重量)	172	172	172
Dimensions(D x L)[mm] (尺寸)		47.2x45	
Length(overall)[mm] (长度)		67	
Diameter of Shaft (mm) (轴径)		6	
Spec. of Mounting Holes (安装孔距)		44	
Slots & Poles (槽数, 极数)		24,28	
Io@10V (A) (空载电流)	2.2	1.6	1.2
Ri(mOhm) (电机内阻)	21	32.3	47
No.of Cells(LiPo) (适用电池)	14.8V, 4S Lipo	18.5V, 5S Lipo	22.2V, 6S Lipo
Peak Power(15S)[W] (峰值功率)	770	851	910
Burst Current (15S) & Peak Torque (峰值电流&峰值扭矩)	52A, 0.77N*M	46A, 0.86N*M	41A, 0.92N*M
Cruising power(8mins)[W] (巡航功率)	335	425	455
Recommended ESC (推荐调速器)	SUMMIT 60X		
Recommended Propeller (螺旋桨)	12x6 for best efficiency, 13x6 for pilots performance, 14x6 for extreme thrust		
Weight of sports airplane	Up to 2.0 kg	Up to 2.1 kg	Up to 2.2 kg
Weight of 3D airplane	1.4 kg to 1.6 kg	1.5 kg to 1.7 kg	1.5 kg to 1.8 kg
Application (适用级别)	Designed for 30E class, 3D airplane (48"-52" wingspan)	For .30E to .40E class F3A & FAI F2B Electric Powered	For .30E to .40E class 3D airplane (48" to 55" wingspan)

注：<sup>1</sup> Good throttle management needed 可在有效控制油门的情况下使用

© 2024 dualsky.com . All rights reserved.

## Dimension 尺寸图

(Unit : mm)

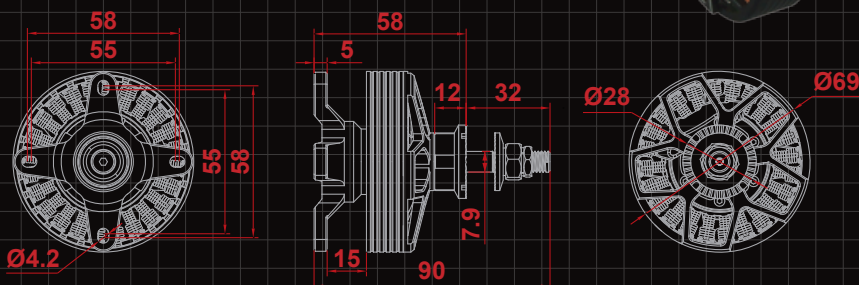

## Specification 规格

GA RACING SERIES	GA1500R.9 MKII	GA1500R.10 MKII	GA1500R.20 MKII
SKU (商品编码)	52246	52247	52248
KV (KV值)	545	490	245
Weight(g) (重量)	305	305	300
Dimensions(D x L)[mm] (尺寸)		69x58	
Length(overall)[mm] (长度)		90	
Diameter of Shaft (mm) (轴径)		D8.0 x 32mm (output)	
Spec. of Mounting Holes (安装孔距)		55 to 58	
Slots & Poles (槽数, 极数)		24,28	
Io@10V (A) (空载电流)	2.3	1.9	0.7
Ri(mOhm) (电机内阻)	12.9	15.5	54.5
No.of Cells(LiPo) (适用电池)	18.5V-22.2V, 5S-6S Lipo		44.4V, 12S Lipo
Peak Power(15S)[W] (峰值功率)	1954	1820	2042
Burst Current (15S) & Peak Torque (峰值电流&峰值扭矩)	88A, 1.93N*M	82A, 2.00N*M	46A, 2.24N*M
Cruising power(8mins)[W] (巡航功率)	977	910	1021
Recommended ESC (推荐调速器)	SUMMIT 100 light	SUMMIT 100 light	Summit 70XHV
Recommended Propeller (螺旋桨)	14x7E to 15x8 for best efficiency, Carbon Fiber 16x7E for pilots performance	15x8E for best efficiency, Carbon Fiber 16x8E for pilots performance	14x6E to 15x8E for best thrust, CF 15x10E for cruising performance
Weight of sports airplane	Up to 7 kg	Up to 6.8 kg	Up to 9 kg
Weight of 3D airplane	Up to 3.3 kg	Up to 3.2 kg	Up to 3.8 kg
Application (适用级别)	Designed for 70E-80E class, 3D airplane (60"-64" wingspan)		Designed for 70E-80E class High Voltage Edition for Fixed Wing Drones

## Dimension 尺寸图

(Unit : mm)

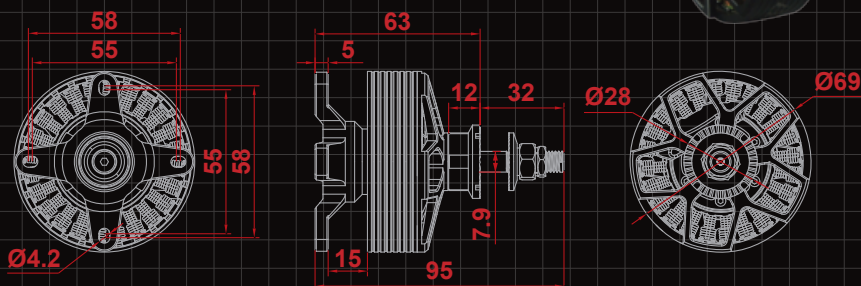

## Specification 规格

GA RACING SERIES	GA2000R.7 MKII	GA2000R.8 MKII	GA2000R.14 MKII
SKU (商品编码)	52249	52250	52251
KV (KV值)	465	405	230
Weight(g) (重量)	384	384	380
Dimensions(D x L)[mm] (尺寸)		69x63	
Length(overall)[mm] (长度)		95	
Diameter of Shaft (mm) (轴径)		D8.0 x 32mm (output)	
Spec. of Mounting Holes (安装孔距)		55 to 58	
Slots & Poles (槽数, 极数)		24,28	
Io@10V (A) (空载电流)	2.5	2.2	0.95
Ri(mOhm) (电机内阻)	12.0	14.6	43.6
No.of Cells(LiPo) (适用电池)	18.5V-22.2V, 5S-6S Lipo		44.4V, 12S Lipo
Peak Power(15S)[W] (峰值功率)	2664	2398	2886
Burst Current (15S) & Peak Torque (峰值电流&峰值扭矩)	120A, 3.08N*M	108A, 3.18N*M	65A, 3.37N*M
Cruising power(8mins)[W] (巡航功率)	1330	1200	1440
Recommended ESC (推荐调速器)	Summit 120	Summit 120	Summit 70XHV
Recommended Propeller (螺旋桨)	17x8E to 18x8E for efficiency flight , Carbon Fiber 18x10E for pilots performance	17x10E to 18x10E for efficiency flight , Carbon Fiber 19x10E for pilots performance	17x8E to 18x8E for Payload Flight , Carbon Fiber 16x13E for cruising performance
Weight of sports airplane	Up to 9 kg	Up to 8.8 kg	Up to 12 kg
Weight of 3D airplane	Up to 4.1 kg	Up to 3.9 kg	Up to 5.5 kg
Application (适用级别)	For 25cc class(equivalent to .120E) 3D airplane(upto 67"-69" wingspan)		Designed for 110E-120E class High Voltage Edition for Fixed Wing Drones

## Dimension 尺寸图

(Unit : mm)

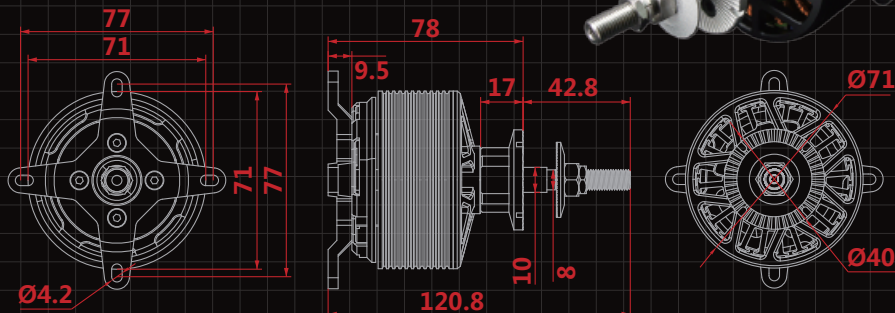

## Specification 规格

GA RACING SERIES	GA3500R.10	GA3500R.11
SKU (商品编码)	52059	52192
KV (KV值)	200	180
Weight(g) (不含配件重量 & 含配件重量)	538 (body only), 628 (w/ accessories)	
Dimensions(D x L)[mm] (尺寸)	71x78	
Length(overall)[mm] (长度)	120.8	
Diameter of Shaft (mm) (轴径)	9 (internal), 8 (output)	
Spec. of Mounting Holes (安装孔距)	71 to 77	
Slots & Poles (槽数, 极数)	24,28	
Io@10V (A) (空载电流)	1.2	1.0
Ri(mOhm) (电机内阻)	28.4	35.5
No.of Cells(LiPo) (适用电池)	30-51V, 10-12S <sup>1</sup> Lipo	
Peak Power(15S)[W] (峰值功率)	3550 (4.9HP)	3460 (4.78HP)
Burst Current (15S) & Peak Torque (峰值电流&峰值扭矩)	80A, 4.68N*M	78A, 5.17N*M
Cruising power(8mins)[W] (巡航功率)	1800	1700
Recommended ESC (推荐调速器)	SUMMIT 120HV	
Recommended Propeller (螺旋桨)	10S: 18x10,19x10,20x10CF,20.5x12 12S: 18x10,19x10,20x10CF,22x10CF	12S: 20x10E to 22x10E PT 21x12WE (8.94kgf, 63.4A@44.4V) Falcon 22x10CF (10.9kgf, 53.7A @44.4V)
Weight of sports airplane	Up to 12 kg	Up to 11 kg
Weight of 3D airplane	Up to 5.5 kg	Up to 5 kg
Application (适用级别)	For 35cc class(equivalent to .170E) 3D airplane(upto 74" -78" wingspan)	

注 : <sup>1</sup> Suggested working voltage(NOC) 建议工作电压(串联节数)

## Dimension 尺寸图

(Unit : mm)

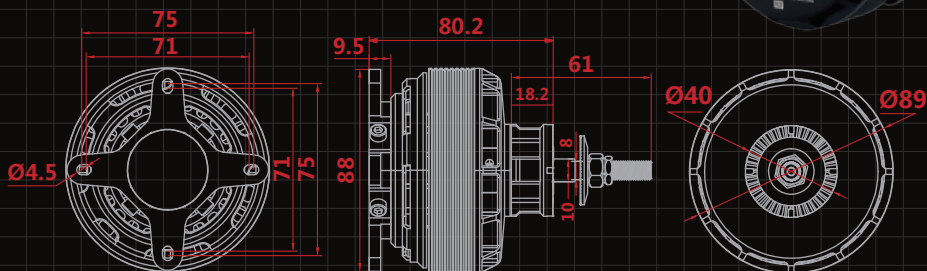

## Specification 规格

GA RACING SERIES	GA4000.6	GA4000.7
SKU (商品编码)	51552	51553
KV (KV值)	210	180
Weight(g) (不含配件重量 & 含配件重量)	700 (body only), 815 (w/ accessories)	
Dimensions(D x L)[mm] (尺寸)		89x80.2
Length(overall)[mm] (长度)		123
Diameter of Shaft (mm) (轴径)		12 (internal), 8 (output)
Spec. of Mounting Holes (安装孔距)		71 to 77
Slots & Poles (槽数, 极数)		24,28
Io@10V (A) (空载电流)	1.8	1.3
Ri(mOhm) (电机内阻)	18.4	23
No.of Cells(LiPo) (适用电池)	37V,10S Lipo	37-51V,10-12S Lipo
Peak Power(15S)[W] (峰值功率)	4000 (5.5HP)	4300 (5.8HP)
Burst Current (15S) (峰值电流)	108A	100A
Cruising power(8mins)[W] (巡航功率)	2000	2100
Recommended ESC (推荐调速器)	SUMMIT 120HV	
Recommended Propeller (螺旋桨)	20x10, 20x12, 22x10	20x10, 20x12, 21x12, 22x10 XOAR 22x10 wooden, 87A@44.4V APC 21x12WE, 13KG, 95A @44.4V
Weight of sports airplane	Up to 10 kg	Up to 10.5 kg
Weight of 3D airplane	Up to 6.5 kg	Up to 6.8 kg
Application (适用级别)	Designed for 35-40cc class 3D airplanes or UAV systems.	

Dimension 尺寸

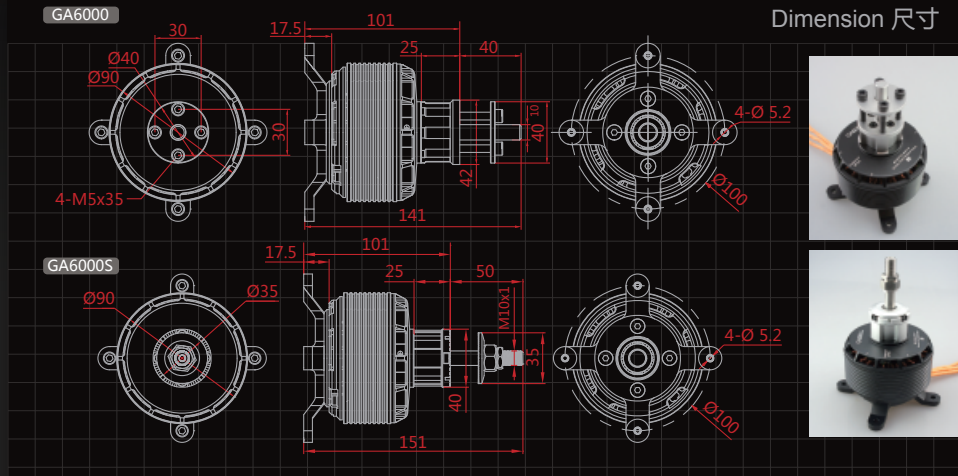

## Specification 规格

NAME 型号	GA6000.8	GA6000.8S	GA6000.9	GA6000.9S
SKU 商品编码	51295	51556	51554	51557
RPM / V (KV) KV值	180		160	
Weight (g) 重量 (不含配件, 含配件)	1020(body only) ,1180g (w/ accessories)		1020 (body only),1180g (w/ accessories)	
Outer Diameter (mm) 直径	90.2		90.2	
Length w/ mounts (mm) 长度带桨座	101		101	
Length (mm) 长度	141	151	141	151
Diameter of Shaft (mm) 轴径	12 (internal, hollow),10 (output)		12 (internal, hollow),10 (output)	
Mounting holes pitch (mm) 安装孔距	100		100	
Slots & Poles 槽数, 极数	24,28		24,28	
Io@10V(A)空载电流	2.1		1.8	
Resistance(Ri)(mOhm) 电机内阻	13.1		17.1	
No.of Cells(LiPo) 适用电池	30V to 51V, 10S-12S Lipo		30V to 51V, 10S-12S Lipo	
Peak power[15s] 峰值功率	6800W(9.2HP) @ 8000RPM		6200W(8.4HP)	
Bursts current[15s](A) 峰值电流	140		130	
Cruising power[8 mins](W) 续航功率	3500 (4.8HP)		3100 (4.2HP)	
Recommended ESC	130A-160A HV Series		130A-160A HV Series	
Propeller 螺旋桨	22x10, 23x8, 23x10(Max. 7650RPM), 24x8, 24x9, 24x10, 25x10 XOAR 24x10CF @ 12S, 125A, Thrust 18KG 油动桨 (NO ELECTIRC PROPELLER ALLOWED) 注意: 电动桨可能会折断		24x10, 24x12, 25x10, 26x10 油动桨 (NO ELECTIRC PROPELLER ALLOWED) 注意: 电动桨可能会折断	
Weight of sports airplane 运动机重量	Up to 17KG		Up to 17KG	
Weight of 3D airplane 3D机重量	Up to 10KG		Up to 10KG	
Applications 适用级别	Designed for 55-60cc class 3D airplanes or UAV systems.		Designed for 55-60cc class 3D or scale warbird airplanes.	

注: 1 Suggested working voltage(NOC) 建议工作电压(串联节数)

2 Good throttle management needed 可在有效控制油门的情况下使用

© 2024 dualsky.com . All rights reserved.

Dimension 尺寸

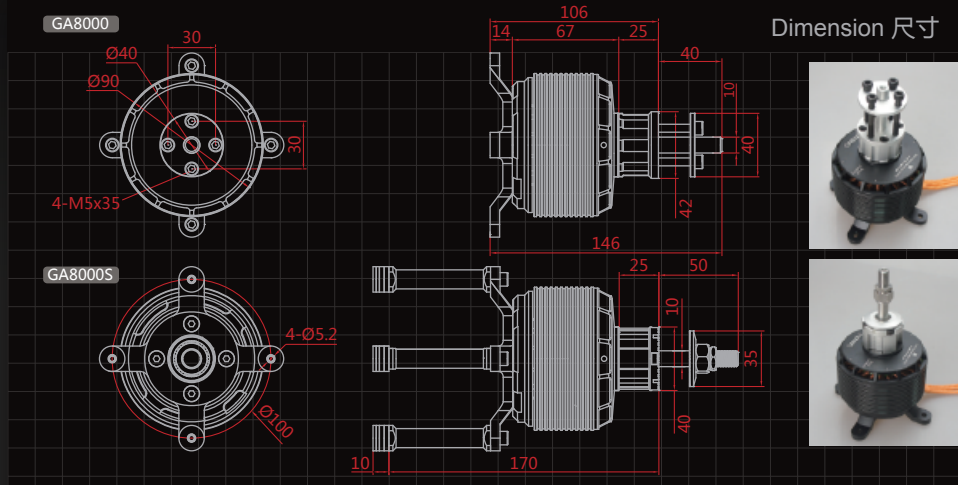

## Specification 规格

NAME 型号	GA8000.8	GA8000.8S	GA8000.9	GA8000.9S
SKU 商品编码	52060	52061	52101	52102
RPM / V (KV) KV值	160		140	
Weight (g) 重量 (不含配件, 含配件)	1140 (body only), 1328g (w/ accessories)		1140 (body only), 1328g (w/ accessories)	
Outer Diameter (mm) 直径	90.2		90.2	
Length w/ mounts (mm) 长度带桨座	106		106	
Length (mm) 长度	146		146	
Diameter of Shaft (mm) 轴径	12 (internal, hollow), 10 (output)		12 (internal, hollow), 10 (output)	
Mounting holes pitch (mm) 安装孔距	100		100	
Slots & Poles 槽数, 极数	24, 28		24, 28	
Io@10V(A) 空载电流	2.35		2.1	
Resistance (Ri) (mOhm) 电机内阻	13.2		17.6	
No. of Cells (LiPo) 适用电池	44.4V to 51.8V, 12S-14S Lipo		44.4V to 51.8V, 12S-14S Lipo	
Peak power [15s] 峰值功率	7992W (11.3HP) @44.4V 9320W (12.7HP) @51.8V		7326W (10.0HP) @44.4V 8550W (11.6HP) @51.8V	
Bursts current [15s] (A) 峰值电流	180		165	
Cruising power [8 mins] (W) 续航功率	4100 (5.6HP)		4000 (5.44HP)	
Torque (mNm) 扭矩	13.56		13.97	
Recommended ESC 推荐调速器	200A and up HV ESC		180A - 200A HV ESC	
Propeller 螺旋桨	12S: 2-blade 26x10, 27x10, 28x10 3-blade 24x10, 24x12, 25x10 14S: 2-blade 25x10, 26x10, 27x9CF (NO ELECTRIC PROPELLER ALLOWED) 油动桨 注意: 电动桨可能会折断		12S: 2-blade 28x10, 28x12, 29x10 3-blade 26x10, 27x10 14S: 2-blade 26x10, 27x10, 28x10 (NO ELECTRIC PROPELLER ALLOWED) 油动桨 注意: 电动桨可能会折断	
Weight of sports airplane 运动机重量	Up to 28KG		Up to 26KG	
Weight of 3D airplane 3D机重量	Up to 14KG		Up to 13KG	
Applications 适用级别	Designed for 80cc to 120cc class UAV, 3D and scale warbird airplanes.		Designed for 76cc to 100cc class UAV, 3D and scale warbird airplanes.	

注: 1 Suggested working voltage (NOC) 建议工作电压 (串联节数)

© 2024 dualsky.com. All rights reserved.

2 Good throttle management needed 可在有效控制油门的情况下使用

## Dimension 尺寸图

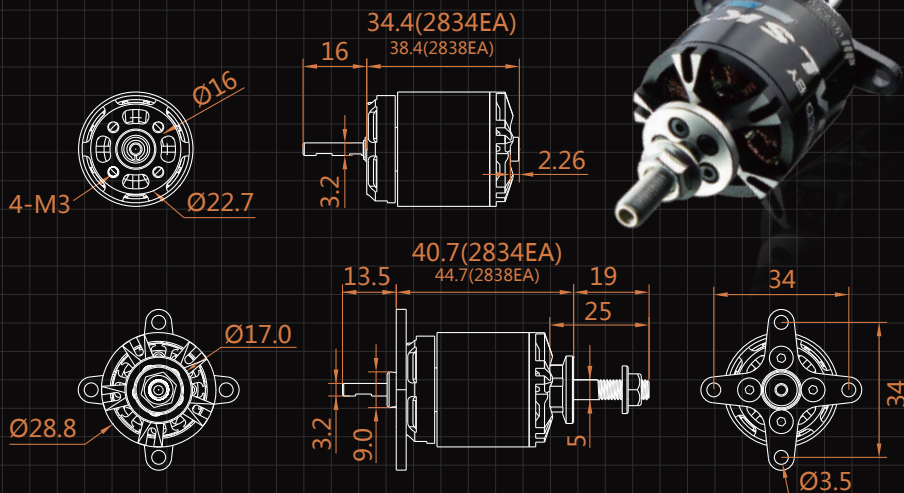

## Specification 规格

EA V3 SERIES	XM2834EA-8	XM2834EA-11	XM2834EA-13
SKU (商品编码)	51850	51851	51852
KV (KV值)	1900	1370	1160
Weight(g) (重量, 不含配件)	78	77	77
Dimensions(D x L)[mm] (尺寸)		28.8x34.4	
Diameter of Shaft (mm) (轴径)		3.175	
Spec. of Mounting Holes (安装孔距)		4-M3, 16/16	
Input Connectors (输入插头)		DB3	
Dimensions of Stator(mm) (定子尺寸)		2316	
Slots & Poles (槽数, 极数)		12N14P	
Ri(mOhm) (电机内阻)	17.5	33.5	43.0
Io@10V (A) (空载电流)	2.6	1.5	1.2
No.of Cells(LiPo) (适用电池)	2..3 <sup>1</sup>	2..3 <sup>1</sup>	2..3 <sup>1</sup>
Efficiency Current[A] (效率电流)	17.5	14.5	13.0
Burst Current (15S)[A] (峰值电流)	35	29	26
Peak Power(15S)[W] (峰值功率)	420	348	312
Peak Torque [N·M] (峰值扭矩)	0.22	0.25	0.27
Recommended ESC (推荐调速器)	XC4018BA	XC3012BA	XC3012BA
Recommended Propeller (螺旋桨)	2S: 10x5E, 10x8E <sup>2</sup> 3S <sup>1</sup> : 7x6E, 8x5E <sup>2</sup>	2S: 12x6E 3S <sup>1</sup> : 9x5E, 10x6E <sup>2</sup>	2S: 12x7E 3S <sup>1</sup> : 10x5E, 11x6E <sup>2</sup>
Application (适用级别)		15E, 480 class	

注: <sup>1</sup> Suggested working voltage(NOC) 建议工作电压(串联节数)

<sup>2</sup> Good throttle management needed 可在有效控制油门的情况下使用

## Dimension 尺寸图

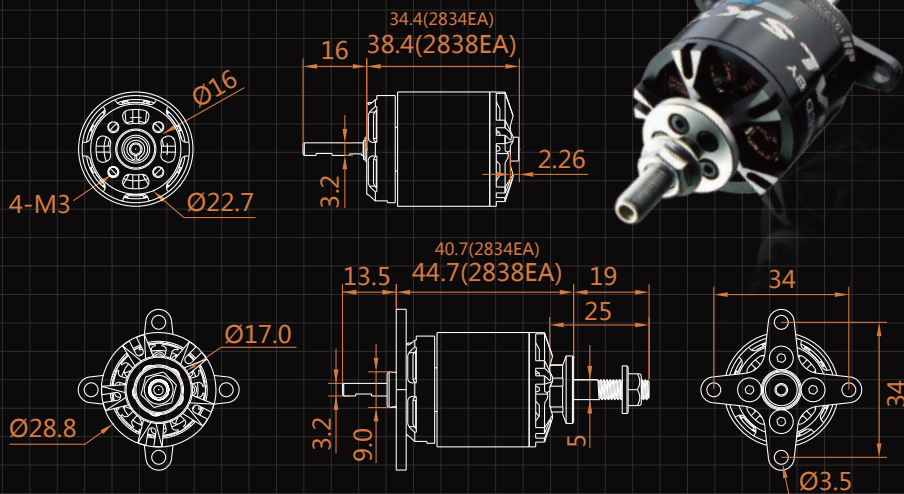

## Specification 规格

EA V3 SERIES	XM2838EA-10	XM2838EA-14	XM2838EA-20
SKU (商品编码)	51853	51854	51855
KV (KV值)	1250	860	600
Weight(g) (重量, 不含配件)	91	91	90
Dimensions(D x L)[mm] (尺寸)		28.8x38.4	
Diameter of Shaft (mm) (轴径)		3.175	
Spec. of Mounting Holes (安装孔距)		4-M3, 16/16	
Input Connectors (输入插头)		DB3	
Dimensions of Stator(mm) (定子尺寸)		2320	
Slots & Poles (槽数, 极数)		12N14P	
Ri(mOhm) (电机内阻)	29.6	54.0	113
Io@10V (A) (空载电流)	1.5	0.9	0.5
No. of Cells(LiPo) (适用电池)	2..3 <sup>1</sup>	3..4 <sup>1</sup>	5..6 <sup>1</sup>
Efficiency Current[A] (效率电流)	16.5	13.0	9.5
Burst Current (15S)[A] (峰值电流)	33	26	19
Peak Power(15S)[W] (峰值功率)	396	416	456
Peak Torque [N·M] (峰值扭矩)	0.32	0.36	0.38
Recommended ESC (推荐调速器)	XC4018BA	XC3012BA	XC2512BA
Recommended Propeller (螺旋桨)	2S: 12x7E	3S: 13x6.5E	5S: 12x6E
	3S <sup>1</sup> : 10x5E, 11x6E <sup>2</sup>	4S <sup>1</sup> : 10x6E, 12x6E <sup>2</sup>	6S <sup>1</sup> : 10x5E, 11x6E <sup>2</sup>
Application (适用级别)	15E Plus, 550 class .15-.21 2-stroke		

注: <sup>1</sup> Suggested working voltage(NOC) 建议工作电压(串联节数)

<sup>2</sup> Good throttle management needed 可在有效控制油门的情况下使用

## Dimension 尺寸图

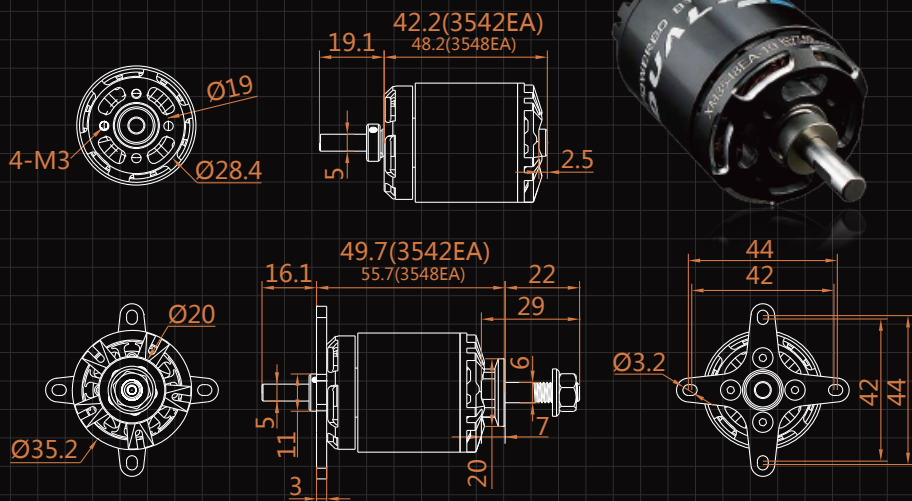

## Specification 规格

EA V3 SERIES	XM3542EA-11	XM3542EA-18
SKU (商品编码)	51856	51857
KV (KV值)	880	540
Weight(g) (重量, 不含配件)	147	144
Dimensions(D x L)[mm] (尺寸)	35.2x42.2	
Diameter of Shaft (mm) (轴径)	5.0	
Spec. of Mounting Holes (安装孔距)	4-M3, 19/19	
Input Connectors (输入插头)	DB3	
Dimensions of Stator(mm) (定子尺寸)	2820	
Slots & Poles (槽数, 极数)	12N14P	
Ri(mOhm) (电机内阻)	25.1	66
Io@10V (A) (空载电流)	1.5	0.7
No.of Cells(LiPo) (适用电池)	3..4 <sup>1</sup>	5..6 <sup>1</sup>
Efficiency Current[A] (效率电流)	19.0	14.0
Burst Current (15S)[A] (峰值电流)	38	28
Peak Power(15S)[W] (峰值功率)	608	672
Peak Torque [N·M] (峰值扭矩)	0.52	0.62
Recommended ESC (推荐调速器)	XC4018BA	XC3012BA
Recommended Propeller (螺旋桨)	3S: 14x7E	5S: 14x7E
	4S <sup>1</sup> : 11x6E, 12x6E <sup>2</sup>	6S <sup>1</sup> : 12x6E
Application (适用级别)	25E, Up to .25 2st	

注：<sup>1</sup> Suggested working voltage(NOC) 建议工作电压(串联节数)

<sup>2</sup> Good throttle management needed 可在有效控制油门的情况下使用

## Dimension 尺寸图

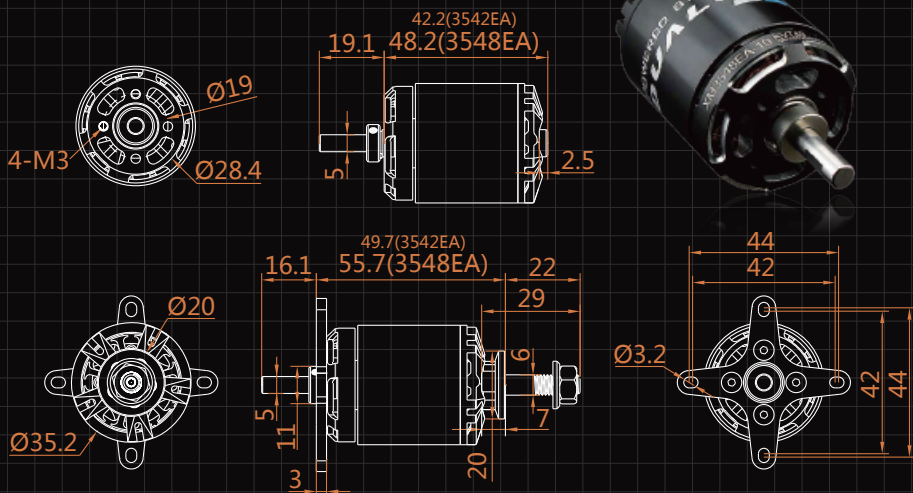

## Specification 规格

EA V3 SERIES	XM3548EA-8	XM3548EA-10	XM3548EA-14
SKU (商品编码)	51858	51859	51860
KV (KV值)	920	740	530
Weight(g) (重量, 不含配件)	177	177	175
Dimensions(D x L)[mm] (尺寸)		35.2x48.2	
Diameter of Shaft (mm) (轴径)		5.0	
Spec. of Mounting Holes (安装孔距)		4-M3, 19/19	
Input Connectors (输入插头)		DB3	
Dimensions of Stator(mm) (定子尺寸)		2826	
Slots & Poles (槽数, 极数)		12N14P	
Ri(mOhm) (电机内阻)	19	27	51
Io@10V (A) (空载电流)	2.2	1.5	0.9
No.of Cells(LiPo) (适用电池)	3..4 <sup>1</sup>	4 <sup>1</sup> .5	5..6 <sup>1</sup>
Efficiency Current[A] (效率电流)	24.0	20.0	17.5
Burst Current (15S)[A] (峰值电流)	48	40	35
Peak Power(15S)[W] (峰值功率)	768	800	840
Peak Torque [N·M] (峰值扭矩)	0.62	0.65	0.79
Recommended ESC (推荐调速器)	XC6018BA	XC4018BA	XC4018BA
Recommended Propeller (螺旋桨)	3S: 14x6E 4S <sup>1</sup> : 11x7E, 12x7E <sup>2</sup>	4S <sup>1</sup> : 14x7E <sup>2</sup> 5S: 12x7E, 13x6.5E <sup>2</sup>	5S: 14x7E, 15x8E 6S <sup>1</sup> : 13x6.5E
Application (适用级别)		32E, .25-.32 2-stroke	

注: <sup>1</sup> Suggested working voltage(NOC) 建议工作电压(串联节数)

<sup>2</sup> Good throttle management needed 可在有效控制油门的情况下使用

## Dimension 尺寸图

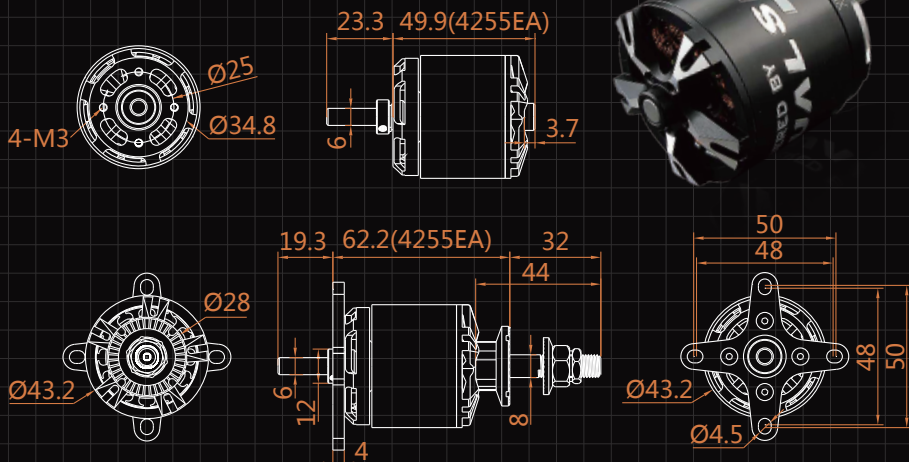

## Specification 规格

EA V3 SERIES	XM4255EA-10	XM4255EA-12
SKU (商品编码)	51861	51862
KV (KV值)	620	520
Weight(g) (重量, 不含配件)	270	269
Dimensions(D x L)[mm] (尺寸)	43.2x49.9	
Diameter of Shaft (mm) (轴径)	6.0	
Spec. of Mounting Holes (安装孔距)	4-M3, 25/25	
Input Connectors (输入插头)	DB4	
Dimensions of Stator(mm) (定子尺寸)	3525	
Slots & Poles (槽数, 极数)	12N14P	
Ri(mOhm) (电机内阻)	16	23.3
Io@10V (A) (空载电流)	1.5	1.2
No.of Cells(LiPo) (适用电池)	5 <sup>1</sup> .6	5..6 <sup>1</sup>
Efficiency Current[A] (效率电流)	31.0	28.0
Burst Current(15S)[A] (峰值电流)	62	56
Peak Power(15S)[W] (峰值功率)	1240	1344
Peak Torque [N·M] (峰值扭矩)	1.19	1.29
Recommended ESC (推荐调速器)	SUMMIT 100	SUMMIT 100
Recommended Propeller (螺旋桨)	5S <sup>1</sup> : 14x7E	5S: 15x8E
	6S: 12x7E, 13x6E, 13x8E <sup>2</sup>	6S <sup>1</sup> : 14x7E
Application (适用级别)	55E, 35-.55 2-stroke. Up to .60 4st	

注: <sup>1</sup> Suggested working voltage(NOC) 建议工作电压(串联节数)

<sup>2</sup> Good throttle management needed 可在有效控制油门的情况下使用

## Dimension 尺寸图

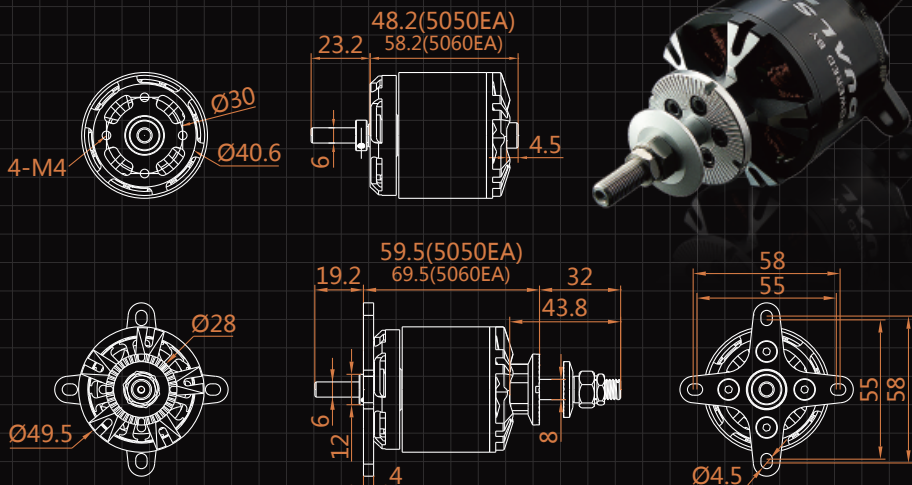

## Specification 规格

EA V3 SERIES	XM5050EA-12	XM5050EA-14	XM5050EA-29SE
SKU (商品编码)	51863	51864	52119
KV (KV值)	610	515	250
Weight(g) (重量, 不含配件)	290	292	290
Dimensions(D x L)[mm] (尺寸)	49.5x48.2		
Diameter of Shaft (mm) (轴径)	6.0		
Spec. of Mounting Holes (安装孔距)	4-M4, 30/30		
Input Connectors (输入插头)	DB4		
Dimensions of Stator(mm) (定子尺寸)	4120		
Slots & Poles (槽数, 极数)	12N14P		
Ri(mOhm) (电机内阻)	14.2	18.5	76
Io@10V (A) (空载电流)	1.8	1.5	0.43
No.of Cells(LiPo) (适用电池)	5 <sup>1</sup> ..6	5 <sup>1</sup> ..6 <sup>1</sup>	10 <sup>1</sup> ..12 <sup>1</sup>
Efficiency Current[A] (效率电流)	35.0	32.5	19.5
Burst Current (15S)[A] (峰值电流)	70	65	40
Peak Power(15S)[W] (峰值功率)	1400	1560	1776
Peak Torque [N·M] (峰值扭矩)	1.37	1.51	1.91
Recommended ESC (推荐调速器)	SUMMIT 100	SUMMIT 100	SUMMIT 100HV
Recommended Propeller (螺旋桨)	5S <sup>1</sup> : 15x8 6S: 12x10E, 14x6E	5S: 16x8E, 17x8E 6S <sup>1</sup> : 15x8E, 16x8E <sup>2</sup>	10S: 15x10E, 16x8E 12S <sup>1</sup> : 15x8E, 15x10E <sup>2</sup>
Application (适用级别)	70E, 50-60 2-stroke. Up to .82 4st		12S HV type for UAV

注: <sup>1</sup> Suggested working voltage(NOC) 建议工作电压(串联节数)

<sup>2</sup> Good throttle management needed 可在有效控制油门的情况下使用

## Dimension 尺寸图

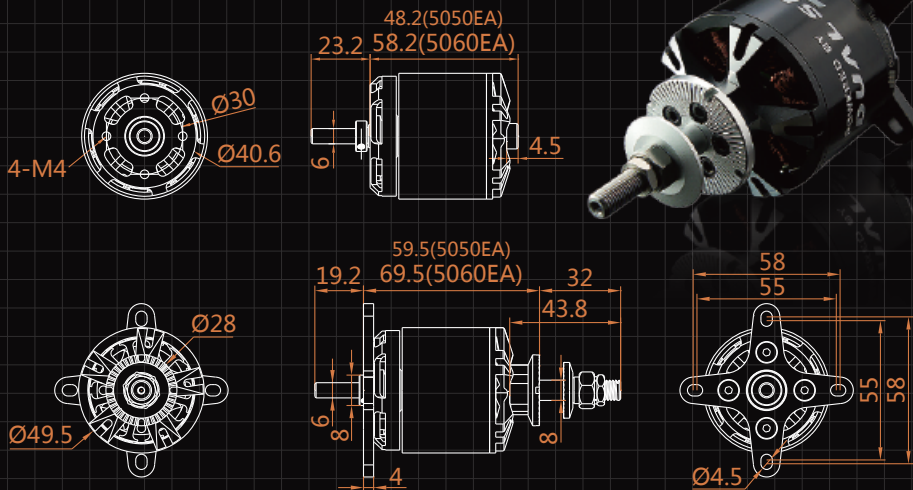

## Specification 参数

NAME 型号	XM5060EA-9	XM5060EA-10	XM5060EA-12	XM5060EA-14SE
SKU 商品编码	51865	51866	51867	52096
RPM / V (KV) KV值	550	490	400	350
Weight (g) 重量	391	392	393	395
Dimensions(D x L)[mm] 尺寸	49.5x58.2			
Diameter of Shaft (mm) 轴径	6.0			
Spec. of Mounting Holes 安装孔距	4-M4, 30/30			
Input Connectors 输入插头	DB4			
Dimensions of Stator (mm) 定子尺寸	4130			
Slots & Poles 槽数, 极数	12N14P			
Io@10V(A)空载电流	2.1	1.8	1.4	1.1
Resistance(Ri)(mOhm) 电机内阻	12.0	14.0	18.5	23.5
No.of Cells(LiPo) 适用电池	5 <sup>1</sup> .6	5,6 <sup>1</sup>	6 <sup>1</sup>	6 <sup>1</sup> .8
EfficiencyCurrent(A) 效率电流	50	47.5	42.5	40
Burst Current (15S)[A] 峰值电流	100	95	85	80
Peak Power(15S)[W] 峰值功率	2000	2280	2040	1920
Peak Torque (mNM) 峰值扭矩	2.17	2.31	2.54	2.73
Recommended ESC 推荐调速器	SUMMIT 100			
Recommended Propeller 螺旋桨	5S <sup>1</sup> : 16x8E, 17x10E <sup>2</sup> 6S: 15x6, 16x8E <sup>2</sup>	5S: 17x8E, 18x10E 6S <sup>1</sup> : 15x8, 16x10E, 17x10E <sup>2</sup>	6S: 16x12E, 17x10E, 17x12E	6S: 17x10E, 17x12E, 18x10E 8S: 15x8E, 16x10E, 17x8E
Applications 适用级别	90E, .75-.90 2-stroke Up to .110 4st			

注: <sup>1</sup> Suggested working voltage(NOC) 建议工作电压(串联节数)

<sup>2</sup> Good throttle management needed 可在有效控制油门的情况下使用

© 2024 dualsky.com . All rights reserved.

## Dimension 尺寸图

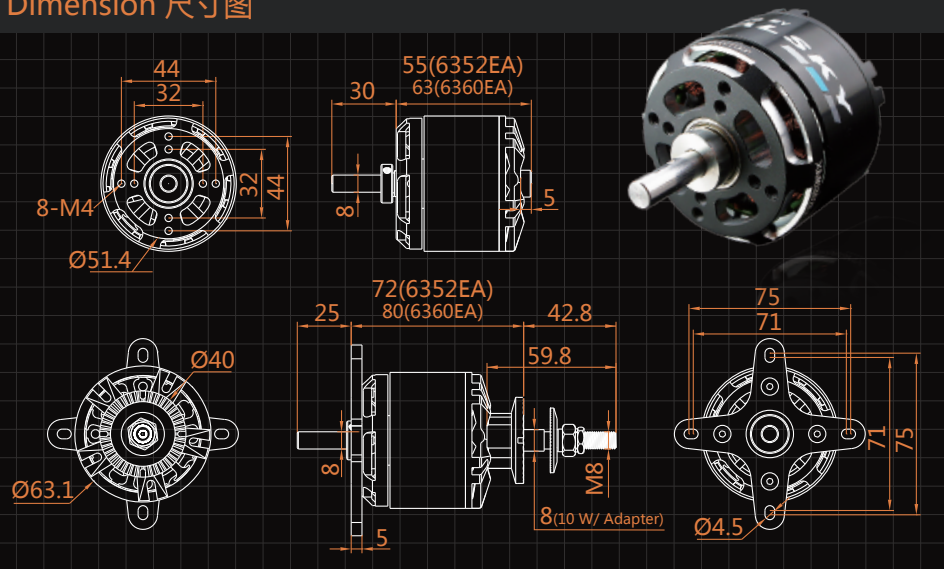

## Specification 规格

EA V3 SERIES	XM6352EA-10	XM6352EA-15	XM6352EA-20
SKU (商品编码)	51788	51868	51869
KV (KV值)	560	380	280
Weight(g) (重量, 不含配件)	515	511	508
Dimensions(D x L)[mm] (尺寸)		63.1x55	
Diameter of Shaft (mm) (轴径)		8.0	
Spec. of Mounting Holes (安装孔距)		4-M4, 32/32	4-M4, 44/44
Input Connectors (输入插头)		DB4	
Dimensions of Stator(mm) (定子尺寸)		5322	
Slots & Poles (槽数, 极数)		12N14P	
Ri(mOhm) (电机内阻)	7.4	15.1	26.3
Io@10V (A) (空载电流)	3.7	1.9	1.2
No.of Cells(LiPo) (适用电池)	5..6 <sup>1</sup>	6 <sup>1</sup> ..8	8
Efficiency Current[A] (效率电流)	60.0	50.0	41.0
Burst Current (15S)[A] (峰值电流)	120	100	82
Peak Power(15S)[W] (峰值功率)	2880	2400	2624
Peak Torque [N·M] (峰值扭矩)	2.56	3.14	3.50
Recommended ESC (推荐调速器)	SUMMIT 120	SUMMIT 120	SUMMIT 120
Recommended Propeller (螺旋桨)	5S: 15x6E, 16x8E 6S <sup>1</sup> : 14x6, 15x8E <sup>2</sup>	6S <sup>1</sup> : 18x12E, 19x12E, 20x10E	8S: 18x12E, 19x10E, 20x10E
Application (适用级别)		125E, .95-.120 2-stroke. Up to .140 4st	

注: <sup>1</sup> Suggested working voltage(NOC) 建议工作电压(串联节数)

<sup>2</sup> Good throttle management needed 可在有效控制油门的情况下使用

## Dimension 尺寸图

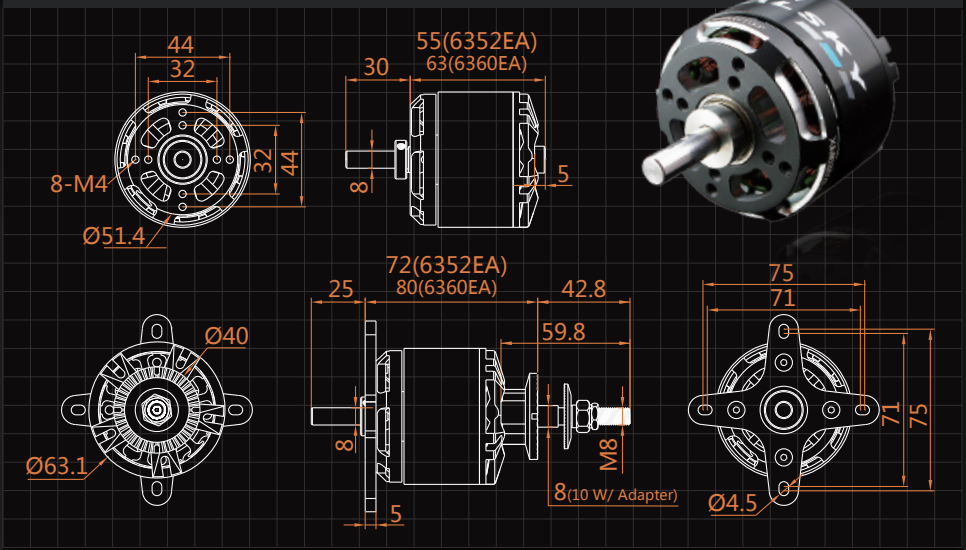

## Specification 规格

EA V3 SERIES	XM6352EA-24SE
SKU (商品编码)	52121
KV (KV值)	240
Weight(g) (重量, 不含配件)	510
Dimensions(D x L)[mm] (尺寸)	63.1x55
Diameter of Shaft (mm) (轴径)	8.0
Spec. of Mounting Holes (安装孔距)	4-M4, 32/32 4-M4, 44/44
Input Connectors (输入插头)	DB4
Dimensions of Stator(mm) (定子尺寸)	5322
Slots & Poles (槽数, 极数)	12N14P
Ri(mOhm) (电机内阻)	36
Io@10V (A) (空载电流)	0.8
No.of Cells(LiPo) (适用电池)	10..12 <sup>1</sup>
Efficiency Current[A] (效率电流)	38.5
Burst Current (15S)[A] (峰值电流)	77
Peak Power(15S)[W] (峰值功率)	3419
Peak Torque [N·M] (峰值扭矩)	3.83
Recommended ESC (推荐调速器)	SUMMIT 100HV
Recommended Propeller (螺旋桨)	10S: 18x12E,19x10E,20x10E <sup>2</sup> 12S <sup>1</sup> : 17x8E,17x10E,18x10E <sup>2</sup>
Application (适用级别)	12S HV type for UAV

注: <sup>1</sup> Suggested working voltage(NOC) 建议工作电压(串联节数)

<sup>2</sup> Good throttle management needed 可在有效控制油门的情况下使用

## Dimension 尺寸图

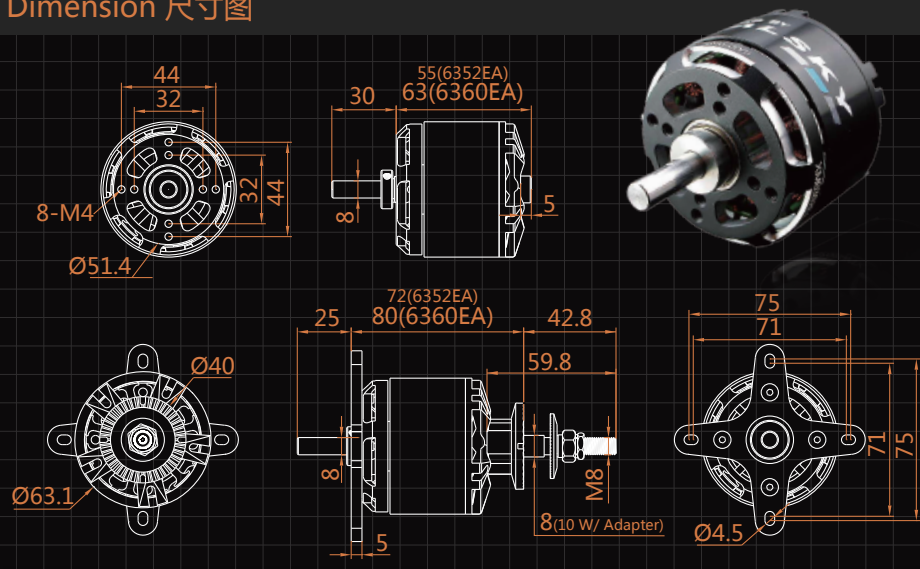

## Specification 规格

EA V3 SERIES	XM6360EA-11	XM6360EA-19	XM6360EA-22
SKU (商品编码)	51870	51871	51872
KV (KV值)	380	220	190
Weight(g) (重量, 不含配件)	650	635	640
Dimensions(D x L)[mm] (尺寸)	63.1x63		
Diameter of Shaft (mm) (轴径)	8.0		
Spec. of Mounting Holes (安装孔距)	4-M4, 32/32		4-M4, 44/44
Input Connectors (输入插头)	DB4		
Dimensions of Stator(mm) (定子尺寸)	5330		
Slots & Poles (槽数, 极数)	12N14P		
Ri(mOhm) (电机内阻)	9.8	28	36
Io@10V (A) (空载电流)	2.6	1.2	1.0
No.of Cells(LiPo) (适用电池)	6 <sup>1</sup> , 8	10 <sup>1</sup>	10..12 <sup>1</sup>
Efficiency Current[A] (效率电流)	65.0	47.5	41.0
Burst Current (15S)[A] (峰值电流)	130	95	82
Peak Power(15S)[W] (峰值功率)	3120	3800	3936
Peak Torque [N·M] (峰值扭矩)	4.08	5.15	5.15
Recommended ESC (推荐调速器)	SUMMIT 120	SUMMIT 120HV	SUMMIT 120HV
Recommended Propeller (螺旋桨)	6S <sup>1</sup> : 20x10E, 20x12E, 22x8E 8S: 17x10, 18x10	10S <sup>1</sup> : 20.5x12WE, 21x13E	10S: 22x12E, 23x10E, 23x12E <sup>2</sup> 12S <sup>1</sup> : 20x10E, 20.5x12WE, 22x10E
Application (适用级别)	170E, .140-.170 2-stroke. Up to .200 4st		

注: <sup>1</sup> Suggested working voltage(NOC) 建议工作电压(串联节数)

<sup>2</sup> Good throttle management needed 可在有效控制油门的情况下使用



## ECO 2303C-V2

### Dimensions

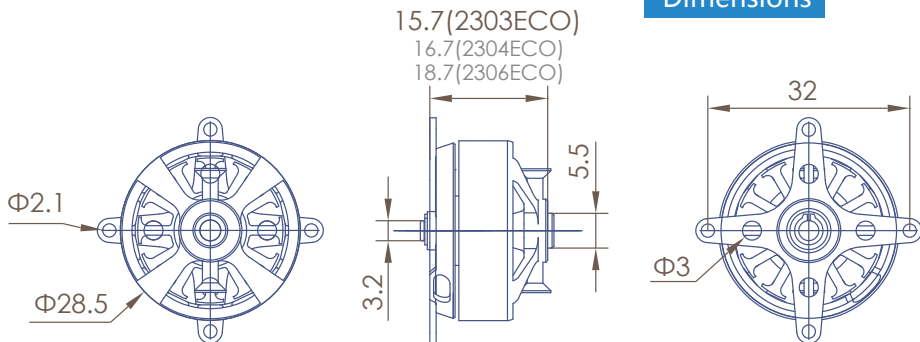

### Specification

ECO-C Series	ECO 2303C		
SKU(商品编码)	51635	51636	51637
KV(KV值)	2000	1800	1470
Turns(匝数)	23	25	31
Weight(g)(重量)	19	19	19
Dimensions(D x L)[mm](尺寸)	28.5x15.7	28.5x15.7	28.5x15.7
Slots & Poles(槽数, 极数)	12N14P	12N14P	12N14P
Ri(mOhm)(电阻)	170.2	276.0	377.0
Io @10V (A)(空载电流)	0.4	0.4	0.3
No.of Cells(LiPo)(适用电池)	2..3	2..3	2..3
Max. EfficiencyCurrent[A](效率电流)	7	6	5
Max. Burst Current (15S)[A](最大电流)	11.5	10	8
Max. Power(15S)[W](最大功率)	92	80	96
Max. Torque [N*M](最大扭矩)	0.066	0.064	0.062
Shaft diameter(mm)(轴径)	3.175	3.175	3.175
Mountingholes pitch(安装孔距)	32	32	32
Input Connectors(输入链接)	GC2.0	GC2.0	GC2.0
RecommendedESC(调速器)	XC-12-LITE or XC1010BA	XC-12-LITE or XC1010BA	XC-12-LITE or XC1010BA
Propeller(螺旋桨)	2S: 7x4E, PT 8x3i 3S: 5x3E	2S: PT 9x3E, 8x4.75F 3S: 5x3E, 5.1x4.5E	2S: 9x4.75F, 10x5E 3S: 7x4E, PT8x2.3i
Class(适用机种)	100-150g airplanes.g. F3P or indoor Freestyle		



Dimensions

## ECO 2304C-V2

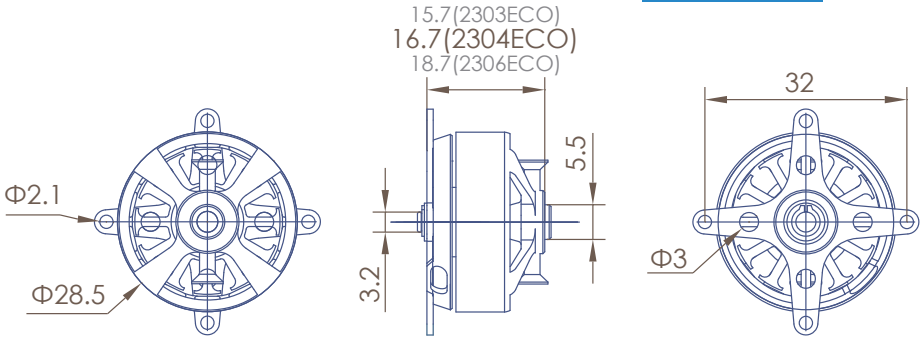

## Specification

ECO-C Series	ECO 2304C		
SKU(商品编码)	51638	51639	51640
KV(KV值)	2300	1850	1450
Turns(匝数)	14.5	18	23
Weight(g)(重量)	23	23	23
Dimensions(D x L)[mm](尺寸)	28.5x16.7	28.5x16.7	28.5x16.7
Slots & Poles(槽数, 极数)	12N14P	12N14P	12N14P
Ri(mOhm)(电阻)	103.0	165.0	230.0
Io @10V (A)(空载电流)	0.6	0.7	0.3
No.of Cells(LiPo)(适用电池)	2..3	2..3	2..3
Max. Efficiency Current[A](效率电流)	9	7.6	6
Max. Burst Current (15S)[A](最大电流)	15	12	10
Max. Power(15S)[W](最大功率)	120	96	120
Max. Torque [N*M](最大扭矩)	0.075	0.074	0.079
Shaft diameter(mm)(轴径)	3.175	3.175	3.175
Mounting holes pitch(安装孔距)	32	32	32
Input Connectors(输入链接)	GC2.0	GC2.0	GC2.0
Recommended ESC(调速器)	XC-12-LITE or XC1210BA	XC-12-LITE or XC1210BA	XC-12-LITE or XC1210BA
Propeller(螺旋桨)	2S: 8x3E, PT 9x2.8i 3S: 5.1x4.5E	2S: 9x4.75F, PT10x2.8i 3S: 5.1x4.5E, 6x3E	2S: 8x4.7E, 9x4.7E 3S: 7x4E, 8x4E
Class(适用机种)	100-200g airplane.g. Indoor freestyle or EPP F3P trainer		



## ECO 2306C-V2

### Dimensions

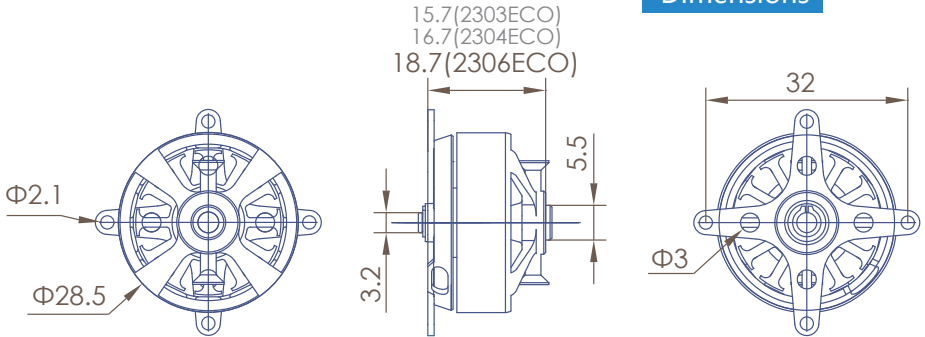

### Specification

ECO-C Series	ECO 2306C		
SKU(商品编码)	51641	51642	51643
KV(KV值)	2300	1900	1500
Turns(匝数)	9.5	11.5	15
Weight(g)(重量)	30	30	30
Dimensions(D x L)[mm](尺寸)	28.8x20.9	28.8x20.9	28.8x20.9
Slots & Poles(槽数, 极数)	12N14P	12N14P	12N14P
Ri(mOhm)(电阻)	61.2	90.6	139.4
I <sub>o</sub> @10V (A)(空载电流)	1.1	0.8	0.5
No.of Cells(LiPo)(适用电池)	2.3	2.3	2.3
Max. EfficiencyCurrent[A](效率电流)	13.5	11	8.5
Max. Burst Current (15S)[A](最大电流)	22.5	18	14.2
Max. Power(15S)[W](最大功率)	180	144	170
Max. Torque [N*M](最大扭矩)	0.112	0.109	0.108
Shaft diameter(mm)(轴径)	3.175	3.175	3.175
Mountingholes pitch(安装孔距)	32	32	32
Input Connectors(输入链接)	GC2.0	GC2.0	GC2.0
RecommendedESC(调速器)	XC-22-LITE or XC1812BA	XC-22-LITE or XC1812BA	XC-12-LITE or XC1210BA
Propeller(螺旋桨)	2S: 8x4E, PT10x30i 3S: 5.1x4.5E, 6x3E	2S: 8x4E, 9x4E 3S: 6x3E, 6x5.5E	2S: 9x6E, 10x5E 3S: 7x5E, 8x4.7E
Class(适用机种)	200-300g airplanes.e.g. Popular EPP profile planes		



Dimensions

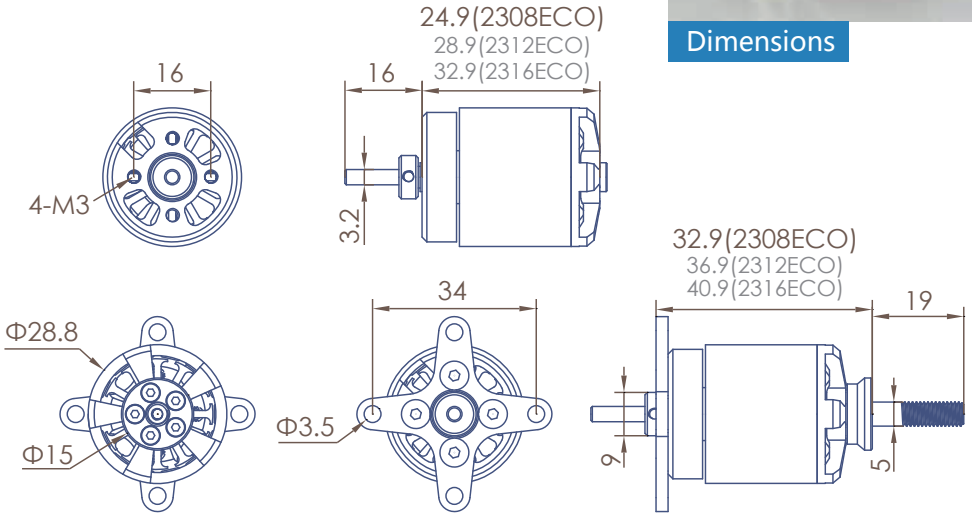

## Specification

ECO-C Series	ECO 2308C			
SKU(商品编码)	51644	51645	51646	51647
KV(KV值)	1800	1500	1180	980
Turns(匝数)	9	11	14	17
Weight(g)(重量)	47	47	47	47
Dimensions(D x L)[mm](尺寸)	28.8x24.9	28.8x24.9	28.8x24.9	28.8x24.9
Slots & Poles(槽数, 极数)	12N14P	12N14P	12N14P	12N14P
Ri(mOhm)(电阻)	68.0	78.0	128.5	189.0
I <sub>o</sub> @10V (A)(空载电流)	1.0	0.7	0.5	0.4
No. of Cells(LiPo)(适用电池)	2..3	2..3	2..3	3..4
Max. EfficiencyCurrent[A](效率电流)	15	14	12	10
Max. Burst Current (15S)[A](最大电流)	25	23	20	17
Max. Power(15S)[W](最大功率)	200	184	240	204
Max. Torque [N*M](最大扭矩)	0.159	0.176	0.194	0.199
Shaft diameter(mm)(轴径)	3.175	3.175	3.175	3.175
Mountingholes pitch(安装孔距)	16/16	16/16	16/16	16/16
Input Connectors(输入链接)	GC3.5	GC3.5	GC3.5	GC3.5
RecommendedESC(调速器)	XC-22-LITE or XC2512BA	XC-22-LITE or XC2512BA	XC-22-LITE or XC2512BA	XC-22-LITE or XC2512BA
Propeller(螺旋桨)	2S: 10x5E, 9x6E 3S: 6x5.5E, 7x3E	2S: 10x5E, 11x5E 3S: 8x4E, 9x4.7E	2S: 11x6E, 10x8E 3S: 9x4.7SF, 9x6E	3S: 9x6E, 10x7E 4S: 7x5E, 8x6E
Class(适用机种)	Wings and Little Jets	400-600g300E class		



Dimensions

## ECO 2312C-V2

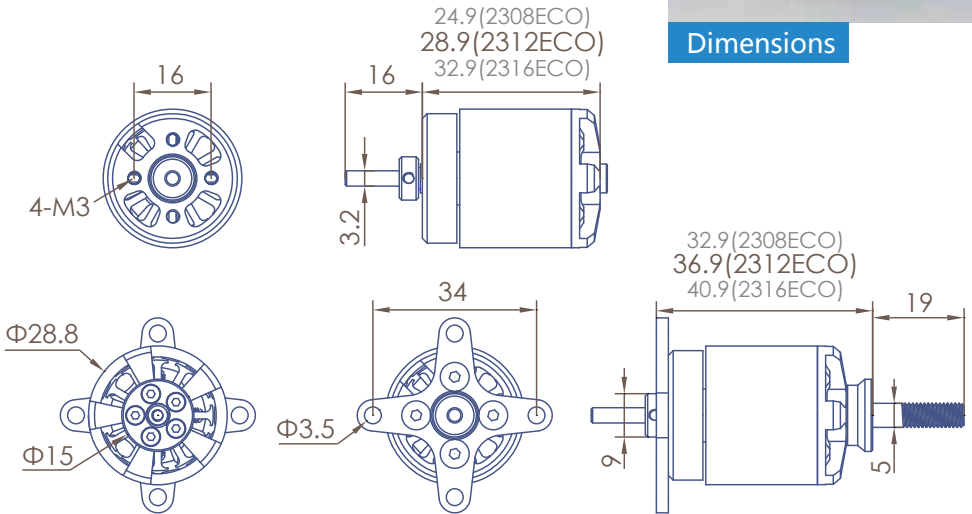

## Specification

ECO-C Series	ECO 2312C		
SKU(商品编码)	51648	51649	51650
KV(KV值)	1500	1150	960
Turns(匝数)	7	9.5	11.5
Weight(g)(重量)	58	58	58
Dimensions(D x L)[mm](尺寸)	28.8x28.9	28.8x28.9	28.8x28.9
Slots & Poles(槽数, 极数)	12N14P	12N14P	12N14P
Ri(mOhm)(电阻)	46.4	90.8	123.5
I <sub>o</sub> @10V (A)(空载电流)	1.1	0.7	0.5
No. of Cells(LiPo)(适用电池)	2.3	2.3	3.4
Max. Efficiency Current[A](效率电流)	16	14	13
Max. Burst Current (15S)[A](最大电流)	26	23	21.5
Max. Power(15S)[W](最大功率)	208	276	258
Max. Torque [N*M](最大扭矩)	0.20	0.23	0.26
Shaft diameter(mm)(轴径)	3.175	3.175	3.175
Mounting holes(安装孔距)	16/16	16/16	16/16
Input Connectors(输入链接)	GC3.5	GC3.5	GC3.5
Recommended ESC(调速器)	XC-22-LITE or XC2512BA	XC-22-LITE or XC2512BA	XC-22-LITE or XC2512BA
Propeller(螺旋桨)	2S: 11x5E, 10X6E 3S: 7X5E, 8X4E	2S: 11X7E, 12X6E 3S: 9x6E, 10x5E	3S: 10x5E, 10X7E 4S: 9X4.5E, 8X6E
Class(适用机种)	400 size, 400-800g sports airplanes		



Dimensions

## ECO 2316C-V2

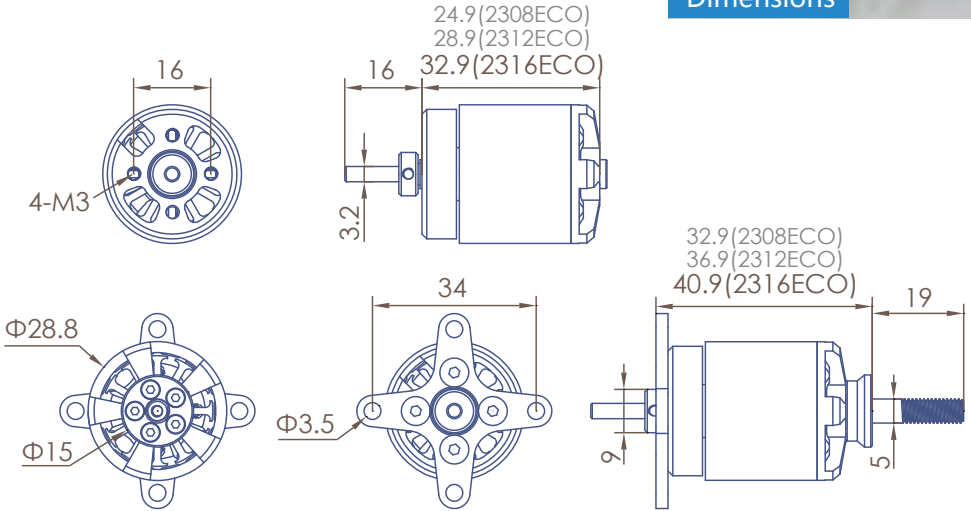

## Specification

ECO-C Series	ECO 2316C			
SKU(商品编码)	51652	51653	51654	51655
KV(KV值)	1500	1250	980	880
Turns(匝数)	5.5	6.5	8.5	9.5
Weight(g)(重量)	72	72	72	72
Dimensions(D x L)[mm](尺寸)	28.8x32.9	28.8x32.9	28.8x32.9	28.8x32.9
Slots & Poles(槽数, 极数)	12N14P	12N14P	12N14P	12N14P
Ri(mOhm)(电阻)	39.0	52.2	80.4	93.0
I <sub>o</sub> @10V (A)(空载电流)	1.4	1.0	0.7	0.6
No.of Cells(LiPo)(适用电池)	2.3	2.3	3.4	3.4
Max. EfficiencyCurrent[A](效率电流)	20	18	15	14
Max. Burst Current (15S)[A](最大电流)	33	30	25	23
Max. Power(15S)[W](最大功率率)	264	360	300	368
Max. Torque [N*M](最大扭矩)	0.25	0.28	0.29	0.30
Shaft diameter(mm)(轴径)	3.175	3.175	3.175	3.175
Mountingholes pitch(安装孔距)	16/16	16/16	16/16	16/16
Input Connectors(输入链接)	GC3.5	GC3.5	GC3.5	GC3.5
RecommendedESC(调速器)	XC-45-LITE or XC3012BA	XC-45-LITE or XC3012BA	XC-45-LITE or XC3012BA	XC-45-LITE or XC3012BA
Propeller(螺旋桨)	2S:11x5.5E,12x6E 3S:7x5E, 8x6E	2S:12x6E,13x6.5E 3S:9x6E,10x7E	3S: 10x5E, 11x7E 4S: 8x6E, 9x6E	3S: 13x8E, 12x6E 4S: 11x4.5E, 10x5E
Class(适用机种)	450 Class, 600-1100g		For 600-1400g airplanes	



Dimensions

## ECO 2808C-V2

28.2(2808ECO)  
34.2(2814ECO)  
40.2(2820ECO)  
46.2(2826ECO)

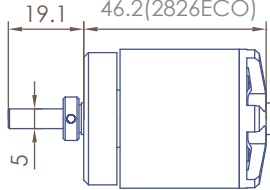
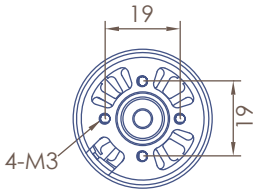

38.2(2808ECO)  
44.2(2814ECO)  
50.2(2820ECO)  
56.2(2826ECO)

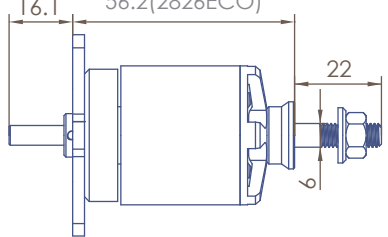
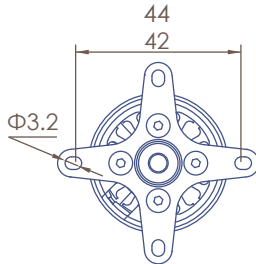
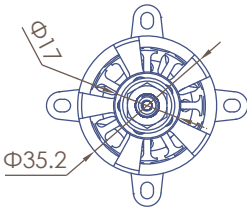

## Specification

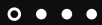

ECO-C Series	ECO 2808C		
SKU(商品编码)	51656	51657	51658
KV(KV值)	1430	1200	1000
Turns(匝数)	9	11	13
Weight(g)(重量)	75	75	75
Dimensions(D x L)[mm](尺寸)	35.2x28.2	35.2x28.2	35.2x28.2
Slots & Poles(槽数, 极数)	12N14P	12N14P	12N14P
Ri(mOhm)(电阻)	48.0	66.6	80.0
I <sub>o</sub> @10V (A)(空载电流)	1.1	0.9	0.6
No. of Cells(LiPo)(适用电池)	2.3	2.3	3.4
Max. Efficiency Current[A](效率电流)	20	17	15
Max. Burst Current (15S)[A](最大电流)	32	28	25
Max. Power(15S)[W](最大功率)	260	336	300
Max. Torque [N*M](最大扭矩)	0.26	0.27	0.29
Shaft diameter(mm)(轴径)	5	5	5
Mounting holes pitch(安装孔距)	19/19	19/19	19/19
Input Connectors(输入链接)	GC3.5	GC3.5	GC3.5
Recommended ESC(调速器)	XC-45-LITE or XC3012BA	XC-45-LITE or XC3012BA	XC-45-LITE or XC3012BA
Propeller(螺旋桨)	2S: 12x6E, 10x5E 3S: 8x5E, 7x5E	2S: 12x6E, 13x6.5E 3S: 10x6E, 9x4.5E	3S: 10x5E, 11x7E 4S: 9x4.5E, 8x6E
Class(适用机种)	480 size.10 Class		



Dimensions

## ECO 2814C-V2

28.2(2808ECO)  
34.2(2814ECO)  
40.2(2820ECO)  
46.2(2826ECO)

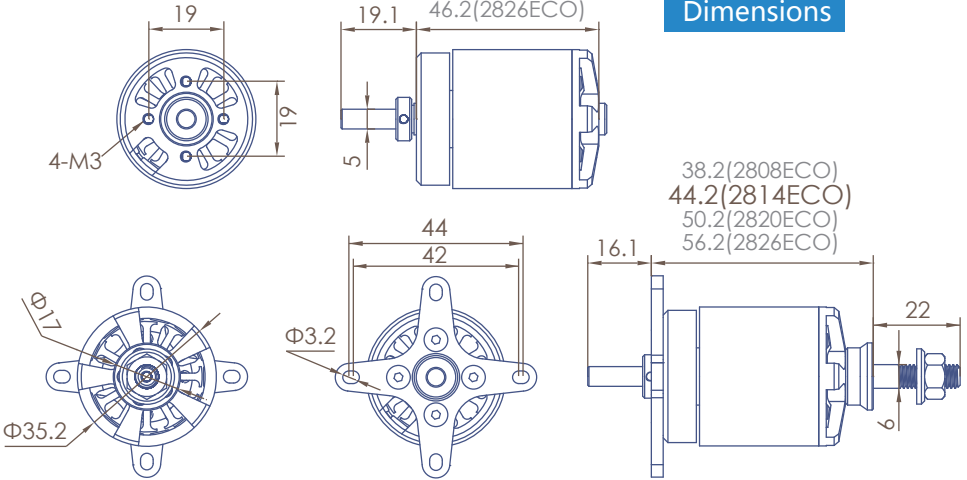

38.2(2808ECO)  
44.2(2814ECO)  
50.2(2820ECO)  
56.2(2826ECO)

## Specification

ECO-C Series	ECO 2814C			
SKU(商品编码)	51659	51660	51661	51662
KV(KV值)	1330	1120	970	860
Turns(匝数)	5.5	6.5	7.5	8.5
Weight(g)(重量)	105	105	105	105
Dimensions(D x L)[mm](尺寸)	35.2x34.2	35.2x34.2	35.2x34.2	35.2x34.2
Slots & Poles(槽数, 极数)	12N14P	12N14P	12N14P	12N14P
Ri(mOhm)(电阻)	29.6	37.8	48.6	63.0
I <sub>o</sub> @10V (A)(空载电流)	1.8	1.2	1.0	0.8
No. of Cells(LiPo)(适用电池)	2.3	2.3	3.4	3.4
Max. Efficiency Current[A](效率电流)	25	22	20	18
Max. Burst Current (15S)[A](最大电流)	40	36	33	30
Max. Power(15S)[W](最大功率)	480	432	400	480
Max. Torque [N*M](最大扭矩)	0.35	0.37	0.39	0.40
Shaft diameter(mm)(轴径)	5	5	5	5
Mounting holes pitch(安装孔距)	19/19	19/19	19/19	19/19
Input Connectors(输入链接)	GC3.5	GC3.5	GC3.5	GC3.5
Recommended ESC(调速器)	XC-45-LITE or XC4018BA	XC-45-LITE or XC4018BA	XC-45-LITE or XC4018BA	XC-45-LITE or XC4018BA
Propeller(螺旋桨)	2S: 12x6E, 13x6.5E 3S: 10x6E, 9x6E	3S: 9x6E, 10x6E, 11x4.5E	3S: 11x7E, 12x6E 4S: 9x6E, 8x4E	3S: 14x8.5E, 13x8E 4S: 12x4E, 10x5E
Class(适用机种)	.10-.15 Class			



Dimensions

## ECO 2820C-V2

28.2(2808ECO)  
34.2(2814ECO)  
40.2(2820ECO)  
46.2(2826ECO)

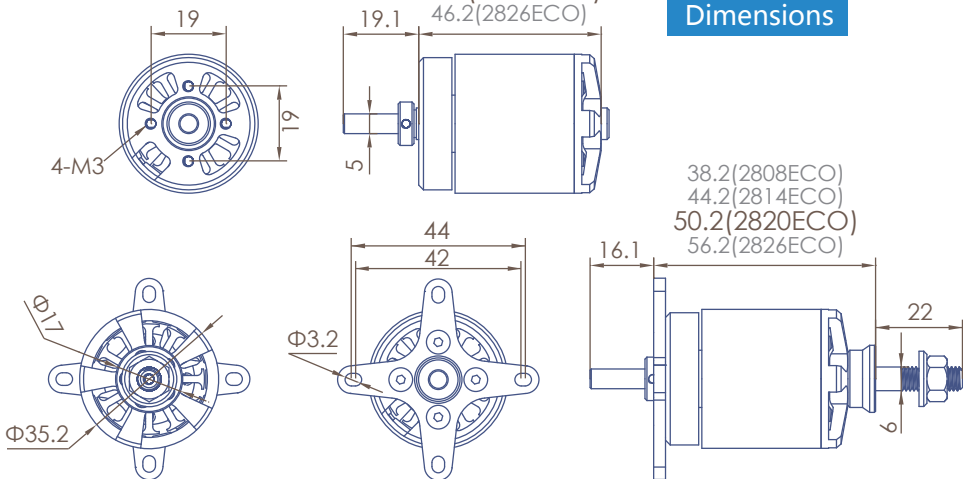

38.2(2808ECO)  
44.2(2814ECO)  
50.2(2820ECO)  
56.2(2826ECO)

## Specification

ECO-C Series	ECO 2820C		
SKU(商品编码)	51663	51664	51665
KV(KV值)	1120	940	800
Turns(匝数)	4.5	5.5	6.5
Weight(g)(重量)	138	138	138
Dimensions(D x L)[mm](尺寸)	35.2x40.2	35.2x40.2	35.2x40.2
Slots & Poles(槽数, 极数)	12N14P	12N14P	12N14P
Ri(mOhm)(电阻)	25.0	34.5	46.0
I <sub>o</sub> @10V (A)(空载电流)	1.8	1.2	0.9
No.of Cells(LiPo)(适用电池)	2.3	3.4	3.4
Max. EfficiencyCurrent[A](效率电流)	28	26	22
Max. Burst Current (15S)[A](最大电流)	45	40	34
Max. Power(15S)[W](最大功率)	540	480	540
Max. Torque [N*M](最大扭矩)	0.46	0.49	0.48
Shaft diameter(mm)(轴径)	5	5	5
Mountingholes pitch(安装孔距)	19/19	19/19	19/19
Input Connectors(输入链接)	GC3.5	GC3.5	GC3.5
RecommendedESC(调速器)	XC-45-LITE or XC4018BA	XC-45-LITE or XC4018BA	XC-45-LITE or XC4018BA
Propeller(螺旋桨)	3S: 12x5E, 11x7E, 10x6E	3S: 12x6E, 13x6.5E 4S: 10x5E, 9x5E	3S: 12x8E, 14x7E 4S: 12x4E, 11x7E
Class(适用机种)		.21-.30 Class	



Dimensions

## ECO 2826C-V2

28.2(2808ECO)  
34.2(2814ECO)  
40.2(2820ECO)  
46.2(2826ECO)

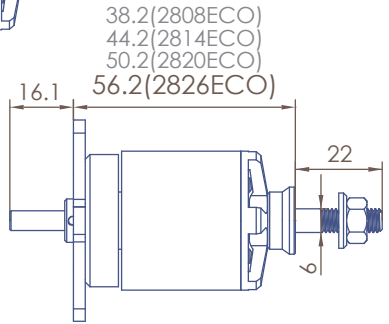
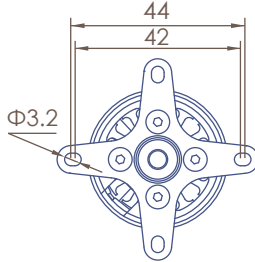
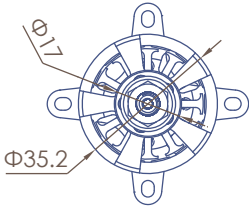
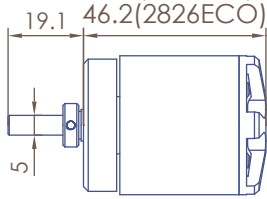
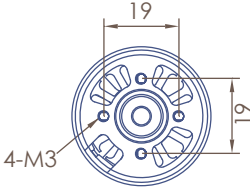

38.2(2808ECO)  
44.2(2814ECO)  
50.2(2820ECO)  
56.2(2826ECO)

## Specification

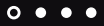

ECO-C Series	ECO 2826C		
SKU(商品编码)	51666	51667	51668
KV(KV值)	1120	850	720
Turns(匝数)	3.5	4.5	5.5
Weight(g)(重量)	167	167	167
Dimensions(D x L)[mm](尺寸)	35.2x46.2	35.2x46.2	35.2x46.2
Slots & Poles(槽数, 极数)	12N14P	12N14P	12N14P
Ri(mOhm)(电阻)	19.3	26.9	43.3
I <sub>o</sub> @10V (A)(空载电流)	2.4	1.7	1.1
No.of Cells(LiPo)(适用电池)	2.3	3.4	4.5
Max. EfficiencyCurrent[A](效率电流)	35	30	25
Max. Burst Current (15S)[A](最大电流)	55	45	38
Max. Power(15S)[W](最大功率)	660	720	750
Max. Torque [N*M](最大扭矩)	0.56	0.61	0.60
Shaft diameter(mm)(轴径)	5	5	5
Mountingholes pitch(安装孔距)	19/19	19/19	19/19
Input Connectors(输入链接)	GC3.5	GC3.5	GC3.5
RecommendedESC(调速器)	XC-65-LITE or XC6018BA	XC-65-LITE or XC6018BA	XC-65-LITE or XC6018BA
Propeller(螺旋桨)	3S: 12x6E, 13x6.5E	3S: 15x8E, 14x7E 4S: 13x6.5E, 12x7E	4S: 14x7E, 13x6.5E 5S: 12x5E, 11x7E

Class(适用机种)

.25-.32 (30E)Class e.g. Extreme Flight 48" airplanes



Dimensions

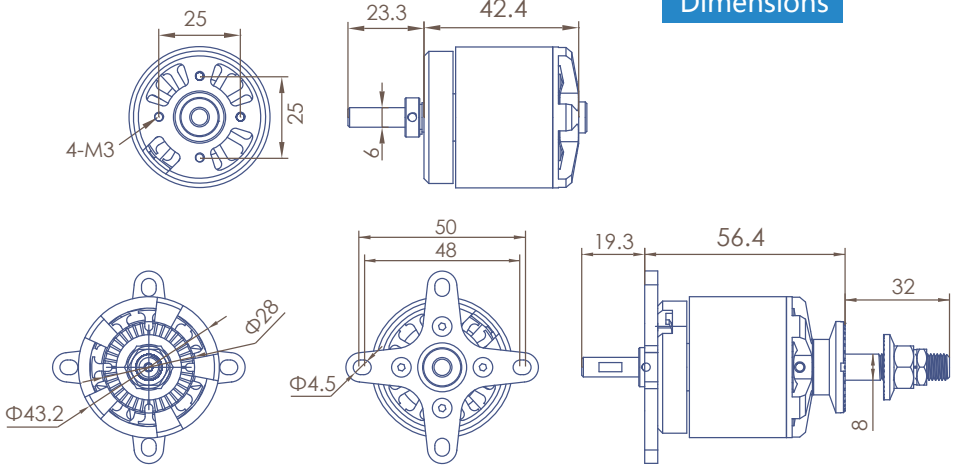

## Specification

ECO-C Series	ECO 3520C			
SKU(商品编码)	51669	51670	51671	51672
KV(KV值)	1020	820	680	510
Turns(匝数)	4	5	6	8
Weight(g)(重量)	210	210	210	210
Dimensions(D x L)[mm](尺寸)	43.2x42.4	43.2x42.4	43.2x42.4	43.2x42.4
Slots & Poles(槽数, 极数)	12N14P	12N14P	12N14P	12N14P
Ri(mOhm)(电阻)	10.8	18.7	24.0	41.6
I <sub>o</sub> @10V (A)(空载电流)	2.6	1.7	1.3	1.2
No. of Cells(LiPo)(适用电池)	3.4	3.4	3.5	5.6
Max. Efficiency Current[A](效率电流)	48	40	33	29
Max. Burst Current (15S)[A](最大电流)	80	65	55	48
Max. Power(15S)[W](最大功率)	960	1040	1100	1150
Max. Torque [N*M](最大扭矩)	0.90	0.91	0.93	1.08
Shaft diameter(mm)(轴径)	6	6	6	6
Mounting holes pitch(安装孔距)	25/25	25/25	25/25	25/25
Input Connectors(输入链接)	GC4.0	GC4.0	GC4.0	GC4.0
Recommended ESC(调速器)	XC8018BA	XC-65-LITE or XC6018BA		
Propeller(螺旋桨)	3S: 14x7E, 13x6.5E 4S: 11x5.5E, 10x5E	4S: 13x8E, 14x7E, 15x6E	4S: 15x10E, 15x8E 5S: 14x5E, 14x7E	5S: 15x8E, 15x6E 6S: 14x6E, 14x7E
Class(适用机种)	.50 4-stroke .32-.40 (40E) 2-stroke			



Dimensions

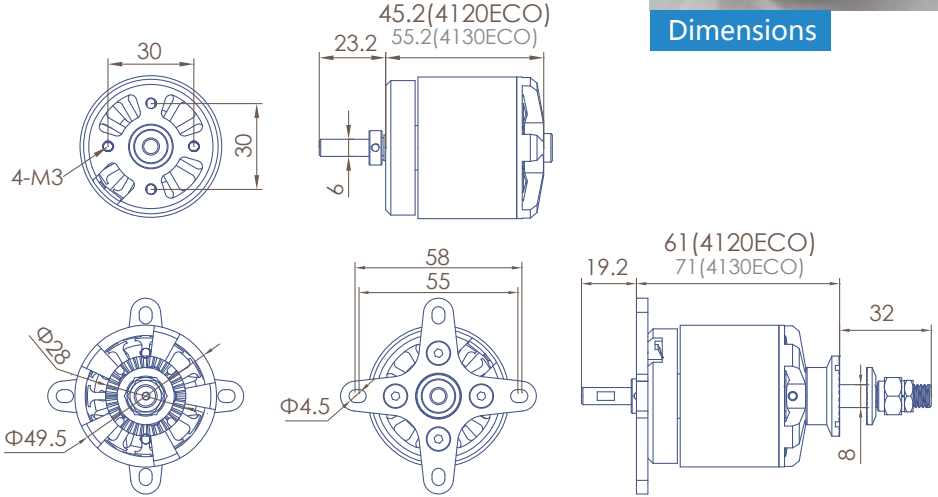

Specification

ECO-C Series	ECO 4120C			
SKU(商品编码)	51673	51674	51675	51676
KV(KV值)	560	500	430	350
Turns(匝数)	7	8	9	11
Weight(g)(重量)	280	280	280	280
Dimensions(D x L)[mm](尺寸)	49.5x45.2	49.5x45.2	49.5x45.2	49.5x45.2
Slots & Poles(槽数, 极数)	12N14P	12N14P	12N14P	12N14P
Ri(mOhm)(电阻)	22.0	25.0	29.2	45.0
I <sub>o</sub> @10V (A)(空载电流)	1.3	1.1	0.9	0.7
No.of Cells(LiPo)(适用电池)	5.6	5.6	5.6	6.8
Max. EfficiencyCurrent[A](效率电流)	42	36	33	29
Max. Burst Current (15S)[A](最大电流)	70	60	55	47
Max. Power(15S)[W](最大功率)	1400	1440	1320	1500
Max. Torque [N*M](最大扭矩)	1.43	1.38	1.47	1.54
Shaft diameter(mm)(轴径)	6	6	6	6
Mountingholes pitch(安装孔距)	30/30	30/30	30/30	30/30
Input Connectors(输入链接)	GC4.0	GC4.0	GC4.0	GC4.0
RecommendedESC(调速器)	XC8018BA	XC-65-LITE or XC6018BA		
Propeller(螺旋桨)	5S: 16x9E, 15x8E 6S: 14x6E, 13x8E	5S: 16x8E, 15x8E 6S: 14x7E, 15x8E	5S: 17x8E, 16x10E 6S: 15x8E, 16x8E	6S: 17x10E, 18x10E 8S: 14x8E, 15x8E
Class(适用机种)	.65-.70 4-stroke	.46-.55 2-stroke	For popular 70E 3A&3D airplanes	



Dimensions

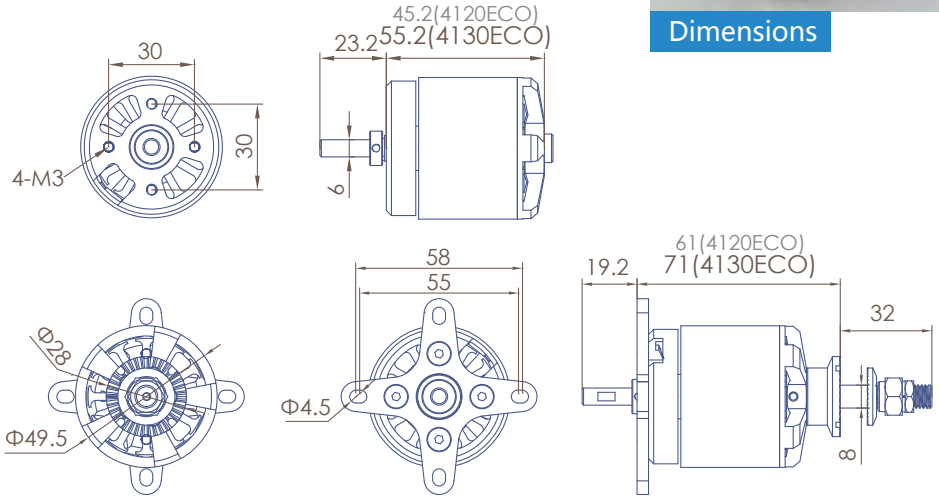

Specification

ECO-C Series	ECO 4130C		
SKU(商品编码)	51677	51678	51686
KV(KV值)	470	375	290
Turns(匝数)	5.5	7	9
Weight(g)(重量)	380	380	380
Dimensions(D x L)[mm](尺寸)	49.5x55.2	49.5x55.2	49.5x55.2
Slots & Poles(槽数, 极数)	12N14P	12N14P	12N14P
Ri(mOhm)(电阻)	16.4	25.2	38.8
I <sub>o</sub> @10V (A)(空载电流)	1.5	1.1	0.8
No.of Cells(LiPo)(适用电池)	5.6	6	8
Max. EfficiencyCurrent[A](效率电流)	54	48	39
Max. Burst Current (15S)[A](最大电流)	90	80	65
Max. Power(15S)[W](最大功率)	1800	1920	2080
Max. Torque [N*M](最大扭矩)	2.20	2.45	2.57
Shaft diameter(mm)(轴径)	6	6	6
Mountingholes pitch(安装孔距)	30/30	30/30	30/30
Input Connectors(输入链接)	GC4.0	GC4.0	GC4.0
RecommendedESC(调速器)	XC8018BA		XC10036HV
Propeller(螺旋桨)	5S: 18x10E, 17x8E 6S: 16x8, 15x8	6S: 17x10E, 17x12E	8S: 17x12E, 18x10E
Class(适用机种)	0.80 - .110 4-stroke		



Dimensions

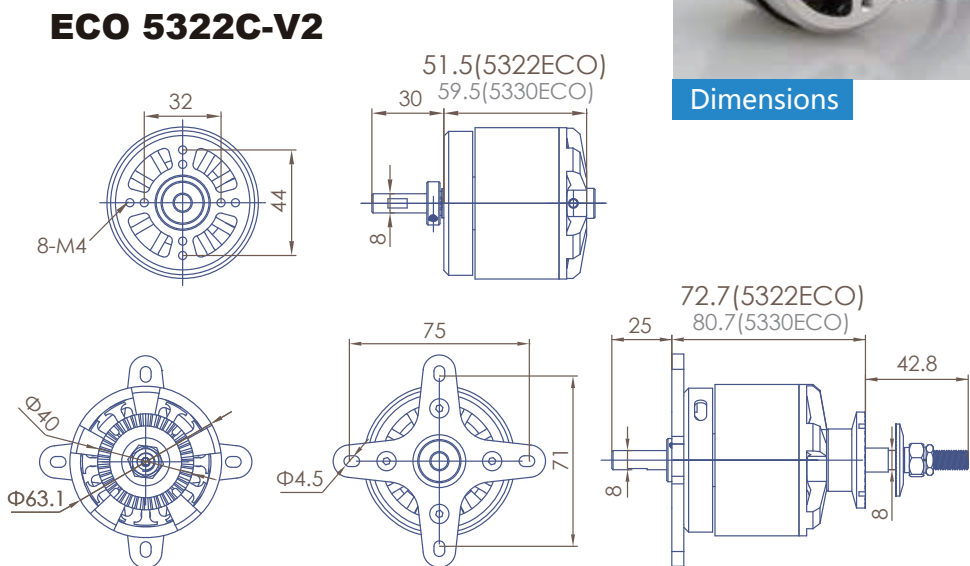

## Specification

ECO-C Series	ECO 5322C		
SKU(商品编码)	51679	51680	51681
KV(KV值)	430	380	300
Turns(匝数)	7	8	10
Weight(g)(重量)	510	510	510
Dimensions(D x L)[mm](尺寸)	63.1x51.5	63.1x51.5	63.1x51.5
Slots & Poles(槽数, 极数)	12N14P	12N14P	12N14P
Ri(mOhm)(电阻)	11.5	15	21.8
I <sub>o</sub> @10V (A)(空载电流)	1.8	1.6	1.1
No.of Cells(LiPo)(适用电池)	5.6	6	8
Max. EfficiencyCurrent[A](效率电流)	60	54	48
Max. Burst Current (15S)[A](最大电流)	100	90	80
Max. Power(15S)[W](最大功率)	2400	2160	2560
Max. Torque [N*M](最大扭矩)	2.67	2.72	3.06
Shaft diameter(mm)(轴径)	8	8	8
Mountingholes pitch(安装孔距)	32/44	32/44	32/44
Input Connectors(输入链接)	GC4.0	GC4.0	GC4.0
RecommendedESC(调速器)	XC10036HV	XC10036HV	XC10036HV
Propeller(螺旋桨)	5S: 19x12E, 20x10E 6S: 18x10E, 19x10E	6S: 19x12E, 20x10E	8S: 19x10E, 18x12E
Class(适用机种)	1.20 - 1.40 4-stroke.g. Sebart Mythos 125E		



## ECO 5330C-V2

### Dimensions

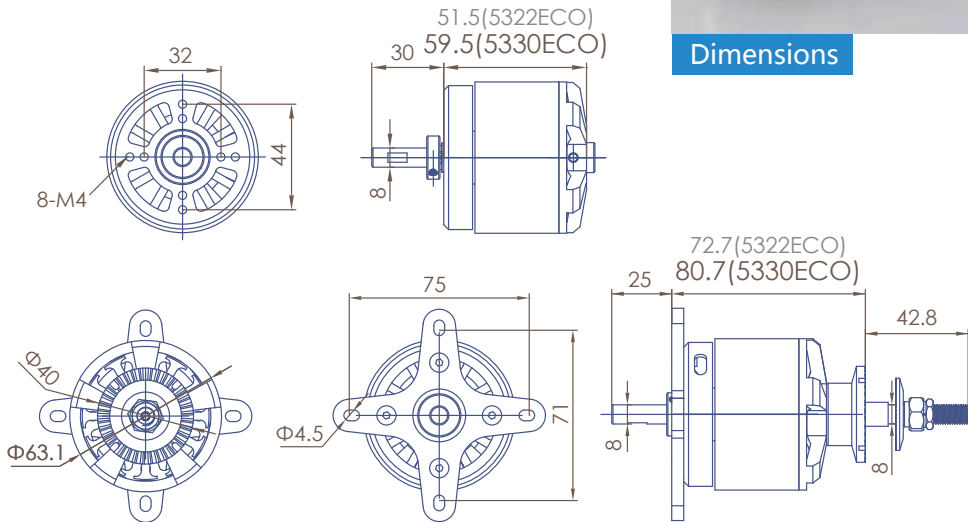

### Specification

ECO-C Series	ECO 5330C		
SKU(商品编码)	51682	51683	51684
KV(KV值)	280	225	205
Turns(匝数)	8	10	11
Weight(g)(重量)	640	640	640
Dimensions(D x L)[mm](尺寸)	63.1x59.5	63.1x59.5	63.1x59.5
Slots & Poles(槽数, 极数)	12N14P	12N14P	12N14P
Ri(mOhm)(电阻)	17.8	36.2	43.0
I <sub>o</sub> @10V (A)(空载电流)	1.4	1.0	0.8
No.of Cells(LiPo)(适用电池)	8	10	10.12
Max. EfficiencyCurrent[A](效率电流)	60	55	50
Max. Burst Current (15S)[A](最大电流)	100	90	85
Max. Power(15S)[W](最大功率)	3200	3600	3400
Max. Torque [N*M](最大扭矩)	4.10	4.59	4.76
Shaft diameter(mm)(轴径)	8	8	8
Mountingholes pitch(安装孔距)	32/44	32/44	32/44
Input Connectors(输入链接)	GC4.0	GC4.0	GC4.0
RecommendedESC(调速器)	XC10036HV	XC10036HV	XC10036HV
Propeller(螺旋桨)	8S: 20x13E, 22x10E	10S: 20.5x12WE, 21x13E, 22x10E	10S: 20.5x12WE, 21x13E, 21x14E 12S: 19x10E, 19x12E
Class(适用机种)	1.40 - 1.80 4-stroke e.g. FAI, F3A & popular 78° 3D models		

Brushless ESC 无刷电子调速器

...

**SUMMIT 30X**  
30amps, 2S-6S Lipo.  
UBEC 6V / 8V,  
3A Cont



SUMMIT 30X .U6 /U8      SUMMIT 30Slim .U6 /U8

**SUMMIT 60X**  
60amps, 2S-6S Lipo.  
UBEC 6V / 8V,  
5A Cont



SUMMIT 60X .U6 /U8      SUMMIT 60Slim .U6 /U8

**XC 8018BA**  
80A, 6-18NDXX  
2S-6S Lipo  
UBEC(5.5V/3A)



**SUMMIT 100 light**



100A Cont, 130A bursts  
BEC 8A Cont, 5-7.4V  
2S-8S Lipo

**SUMMIT 120**



120A Cont, 150A bursts  
BEC 8A Cont, 5-7.4V  
2-8S Lipo

**XC 13036HV**



130A (150A, 15S)W/ 12S Lipo,  
150A(180A, 15S)W/ 6S Lipo,  
High Voltage & Heavy duty  
5S-12S Lipo, No BEC (OPTO)

**SUMMIT 100HV**



100A Cont,  
120A bursts  
4-14S Lipo  
OPTO

**SUMMIT 120HV**



120A Cont,  
150A bursts  
4S-14S Lipo  
OPTO

**SUMMIT 70 XHV**



70A Cont,  
High Voltage  
5S-14S Lipo

**SUMMIT 100 XHV**



100A Cont,  
High Voltage  
5S-14S Lipo

**SUMMIT 130 XHV**



130A Cont,  
High Voltage  
5S-14S Lipo

**SUMMIT 160 XHV**



160A Cont,  
High Voltage  
5S-14S Lipo

**SUMMIT 180 XHV**

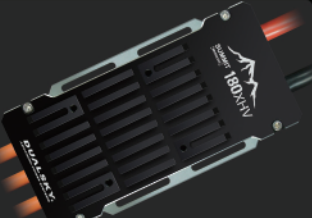

180A Cont,  
High Voltage  
5S-14S Lipo

**SUMMIT 220 XHV**



220A Cont,  
High Voltage  
5S-14S Lipo

» 详细规格及拉力数据表

More Specifications and Propeller Thrust Datasheets ( Download Tab )

Description	Item Number	Download
> GA2000R-MKII-SPEC		
> GA1500R-MKII-SPEC		
> GA800-MKII-SPEC		



GA Series



EA Series



ECO-C Series